

R336 WEST (MCA0)

R336 EAST (MCB0)

R336 ACCESS ROAD (AR 0/01)

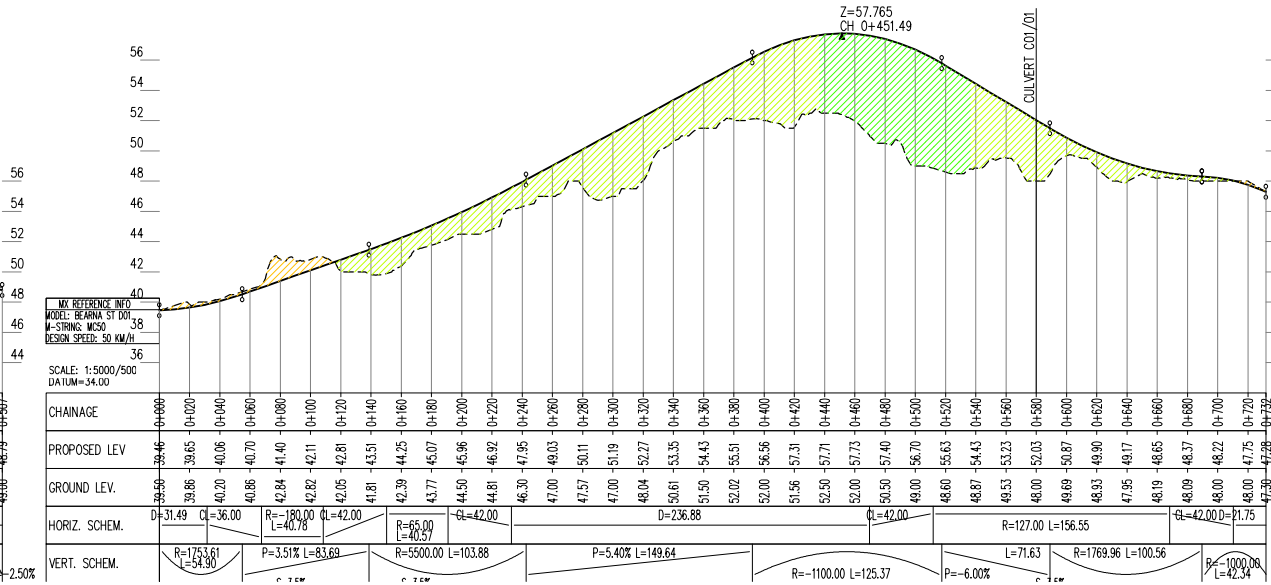
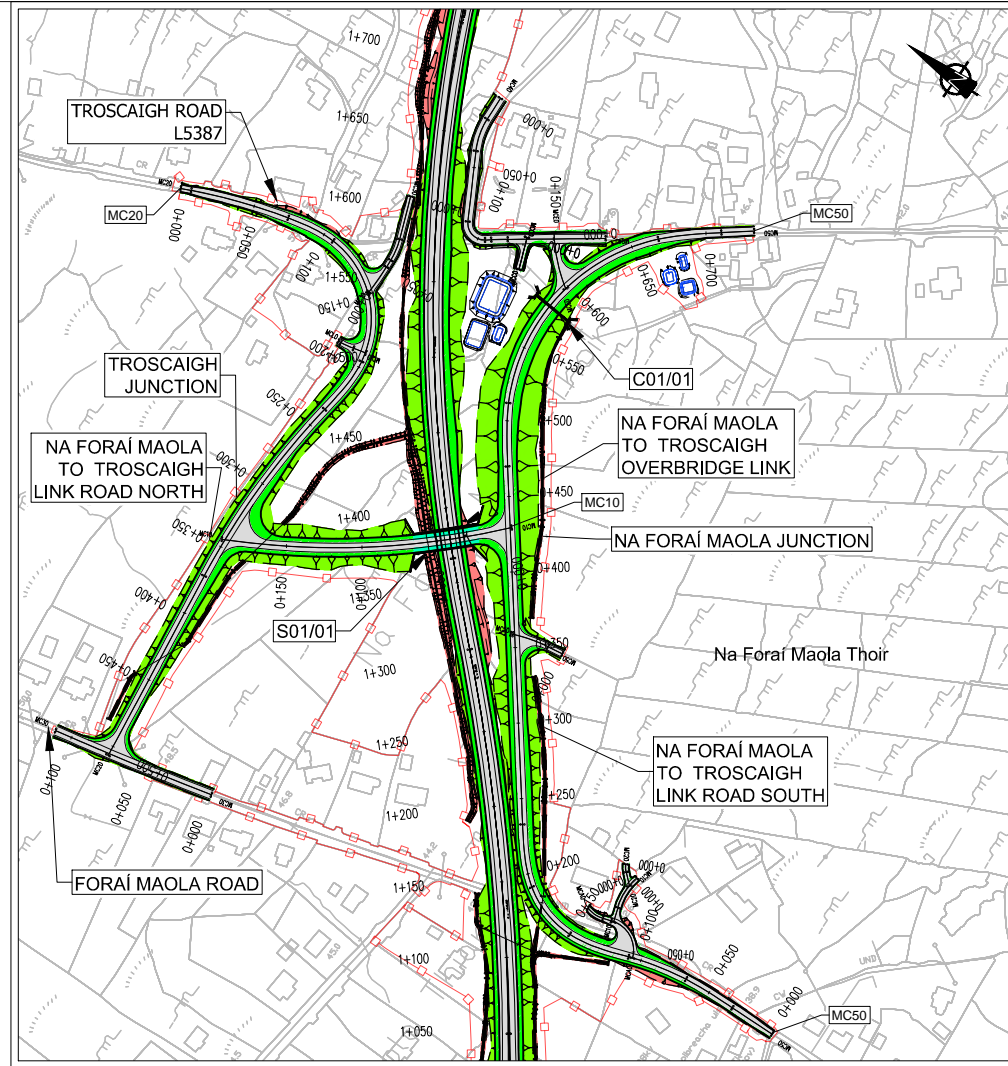

NA FORAI MAOLA TO TROSCAIGH LINK ROAD (SOUTH) (MC50)

**EIA REPORT**

**Legend:**

- Plan
- City Boundary
- Proposed Development Boundary
- Proposed Road Development
- Earthworks - Fill
- Earthworks - Cut
- Proposed Carriageway Pavement
- Proposed Grass Verge
- Proposed Bus Lane
- Proposed Cycleway
- Proposed Footpath
- Proposed Shared Footpath/Cycleway
- Proposed Traffic Island
- Structure (S)
- Proposed Retaining wall (R)
- Proposed Culvert (C)
- Proposed Mammal Underpass (C)
- Proposed Attenuation Pond / Infiltration Basin / Wetlands
- Proposed Stream Diversion

**Profile**

- Existing Ground
- Proposed Geometry Profile
- FILL 15m +
- FILL 10m - 15m
- FILL 05m - 10m
- FILL 00m - 05m
- CUT 00m - 05m
- CUT 05m - 10m
- CUT 10m - 15m
- CUT 15m +

Sun áiríamh tá sonraíocht Shuirbhíreacht Orlándaí Éireann arna áirígeadh faoi Chuidinás OSI Uimh. 2010/20CCMA/Comhairle Contae na Gaillimhe. Sárúin ar áirígeadh neamhdáiríocht cíoscheart Shuirbhíreacht Orlándaí Éireann agus Rialtas na hÉireann. © Suirbhíreacht Orlándaí Éireann, 2010.

© Suirbhíreacht Orlándaí Éireann. Gach ceart ar chosaint. Uimhir cheadúnais 2010/20CCMA/Comhairle Contae na Gaillimhe.

Includes Ordnance Survey Ireland data reproduced under OSI Licence number 2010/20CCMA/Galway County Council. Unauthorised reproduction infringes Ordnance Survey Ireland and Government of Ireland copyright. © Ordnance Survey Ireland, 2010.

© Ordnance Survey Ireland. All rights reserved. Licence number 2010/20CCMA/Galway County Council.

Clients

An Roinn Iompair Tarsairíochta agus Spóirt

Project Ireland 2040

Galway City Transport Project

Comhairle Chontae na Gaillimhe Galway County Council

TIU

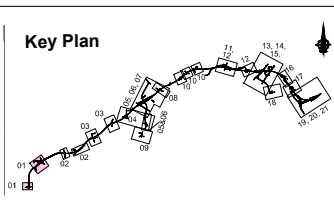

Consultant

**ARUP**

Corporate House  
City East Business Park  
Ballybriff, Galway, Ireland.

Tel +353 (0)91 460675  
www.NGalwayCity.ie  
www.arup.ie

Job Title

**N6 Galway City Ring Road**

Scale

1:2500/250 @ A1; 1:5000/500 @ A3

Date

September 2018

Issue	Date	By	Chkd	Appd
13	17/02/2020	KJ	HK	EMC
11	28/09/2018	KJ	MG	EMC

Drawing Title

**Proposed Road Development Plan & Profile  
Bearna West Roundabout, Forai Maola & Troscaigh Junctions  
Sheet 1 of 21**

Drawing Status

**For Information**

Job No

**233985**

Drawing No

**Figure 5.3.01**

Issue

**13**

- Legend:**
- Plan
  - City Boundary
  - Proposed Development Boundary
  - Proposed Road Development
  - Earthworks - Fill
  - Earthworks - Cut
  - Proposed Carriageway Pavement
  - Proposed Grass Verge
  - Proposed Bus Lane
  - Proposed Cycleway
  - Proposed Footpath
  - Proposed Shared Footpath/Cycleway
  - Proposed Traffic Island
  - Structure (S)
  - Proposed Retaining wall (R)
  - Proposed Culvert (C)
  - Proposed Mammal Underpass (C)
  - Proposed Attenuation Pond / Infiltration Basin / Wetlands
  - Proposed Stream Diversion

- Profile**
- Existing Ground
  - Proposed Geometry Profile
  - FILL 15m +
  - FILL 10m - 15m
  - FILL 05m - 10m
  - FILL 00m - 05m
  - CUT 00m - 05m
  - CUT 05m - 10m
  - CUT 10m - 15m
  - CUT 15m +

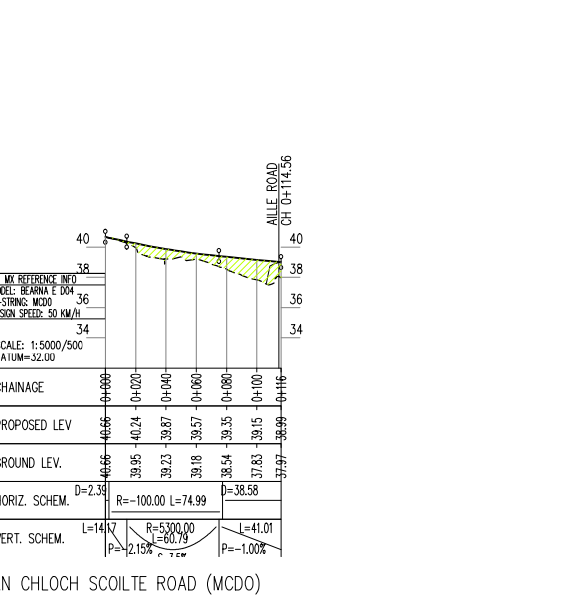
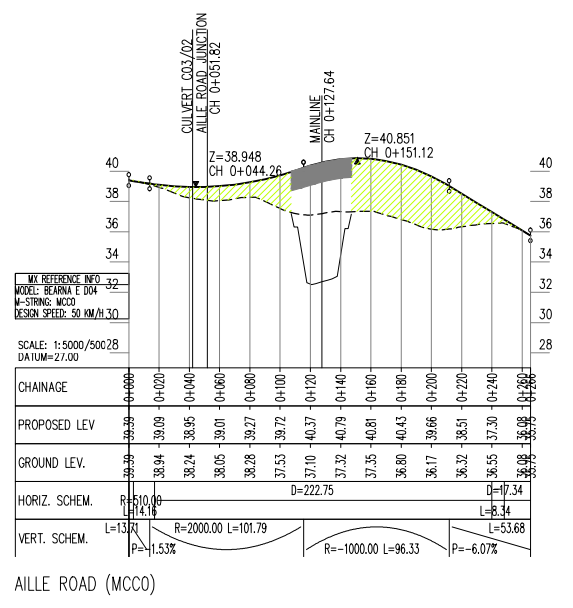
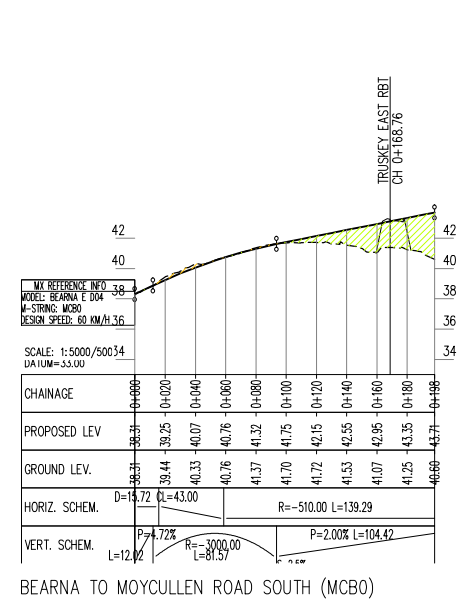
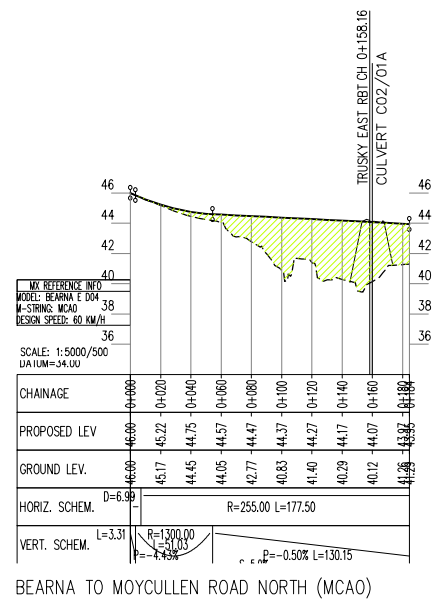
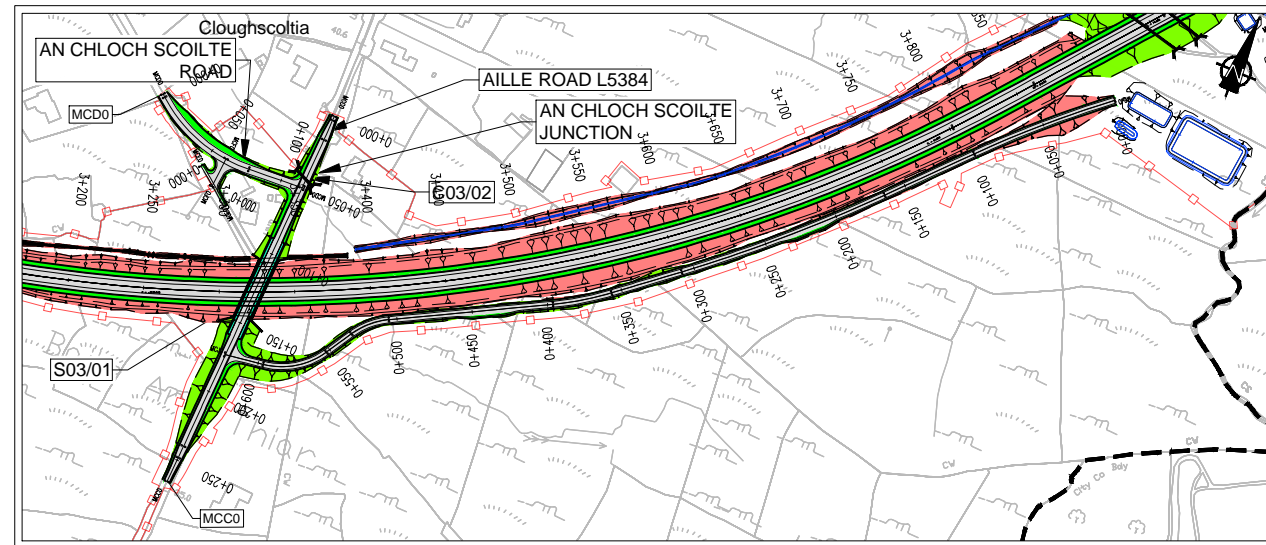
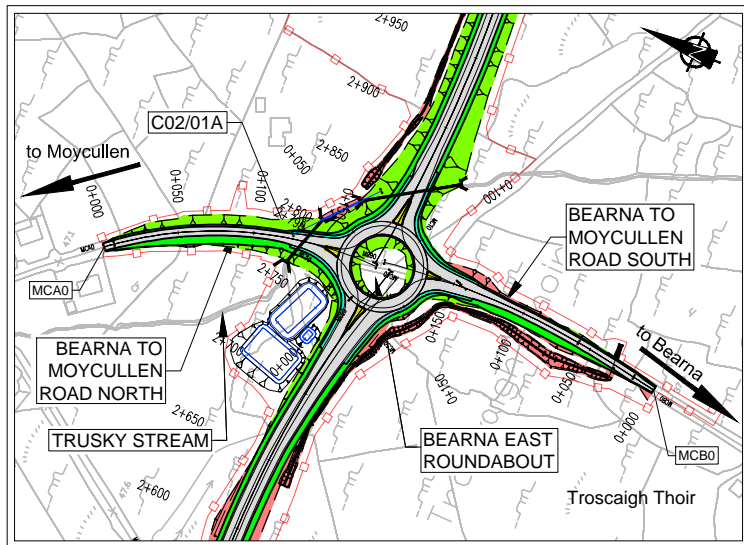

San áiríamh tá sonraíocht Shuirbhíreacht Orlándaí Éireann arna áirígeadh fíor Cheadúnas OSI Uimh. 2010/20CCMA/Comhairle Contae na Gaillimhe. Sárúinn áirígeadh neamhdáraithe cóipeacht Shuirbhíreacht Orlándaí Éireann agus Rialtas na hÉireann. © Suirbhíreacht Orlándaí Éireann, 2010.

© Suirbhíreacht Orlándaí Éireann. Gach ceart ar chosaint. Uimhir cheadúnais 2010/20CCMA/Comhairle Contae na Gaillimhe.

Includes Ordnance Survey Ireland data reproduced under OSI Licence number 2010/20CCMA/Galway County Council. Unauthorised reproduction infringes Ordnance Survey Ireland and Government of Ireland copyright. © Ordnance Survey Ireland, 2010.

© Ordnance Survey Ireland. All rights reserved. Licence number 2010/20CCMA/Galway County Council.

Clients

An Roinn Iompair Turasoireachta agus Spóirt  
Department Transport, Tourism and Sport

Project Ireland 2040  
The Big Ideas for a Better Future

Galway City Transport Project

Comhairle Chontae na Gaillimhe  
Galway County Council

TIIV  
Transport Infrastructure Ireland

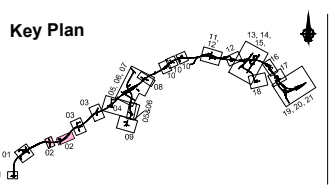

Consultant

**ARUP**

Corporate House  
City East Business Park  
Ballybrit, Galway, Ireland.

Tel +353 (0)91 460675  
www.N6GalwayCity.ie  
www.arup.ie

Job Title

N6 Galway City Ring Road

Scale

1:2500/250 @ A1; 1:5000/500 @ A3

Date:

September 2018

Issue	Date	By	Chkd	Appd
13	17/02/2020	KJ	HK	EMC
11	28/09/2018	KJ	MG	EMC

Drawing Title

Proposed Road Development Plan & Profile  
Bearna East Roundabout & An Chloch Scoilte Junction  
Sheet 2 of 21

Drawing Status

**For Information**

Job No  
**233985**

Drawing No  
**Figure 5.3.02**

Issue  
**13**

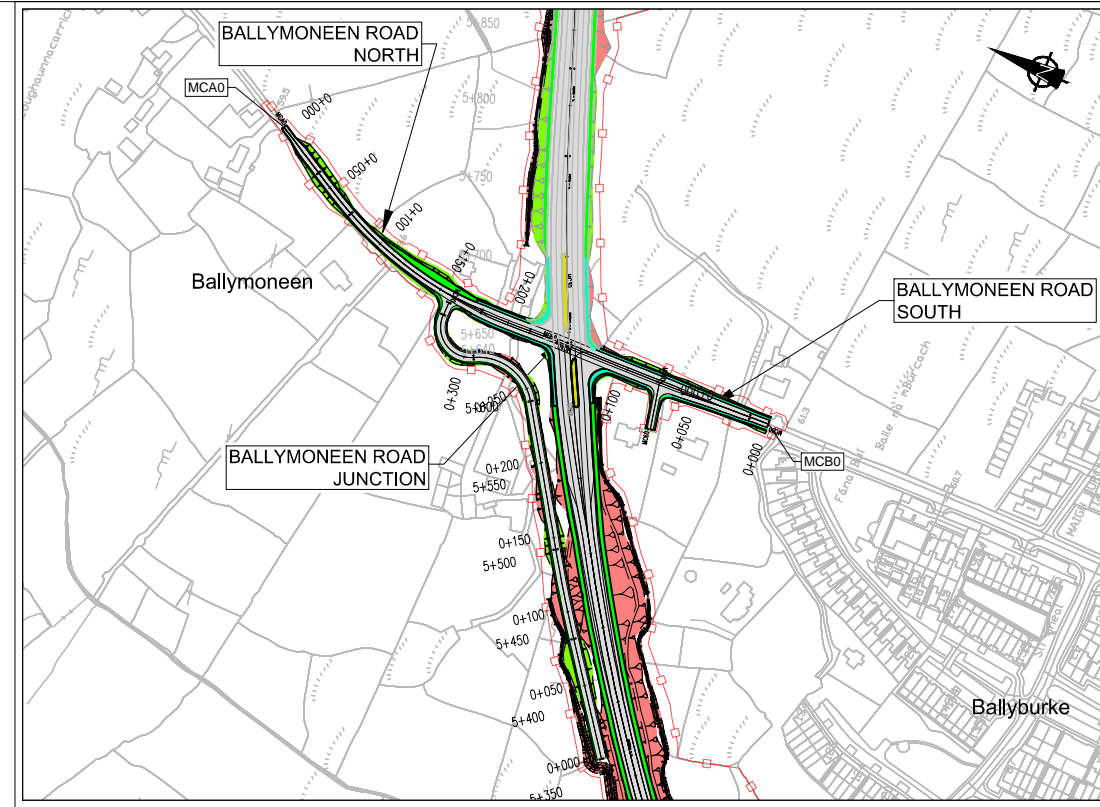
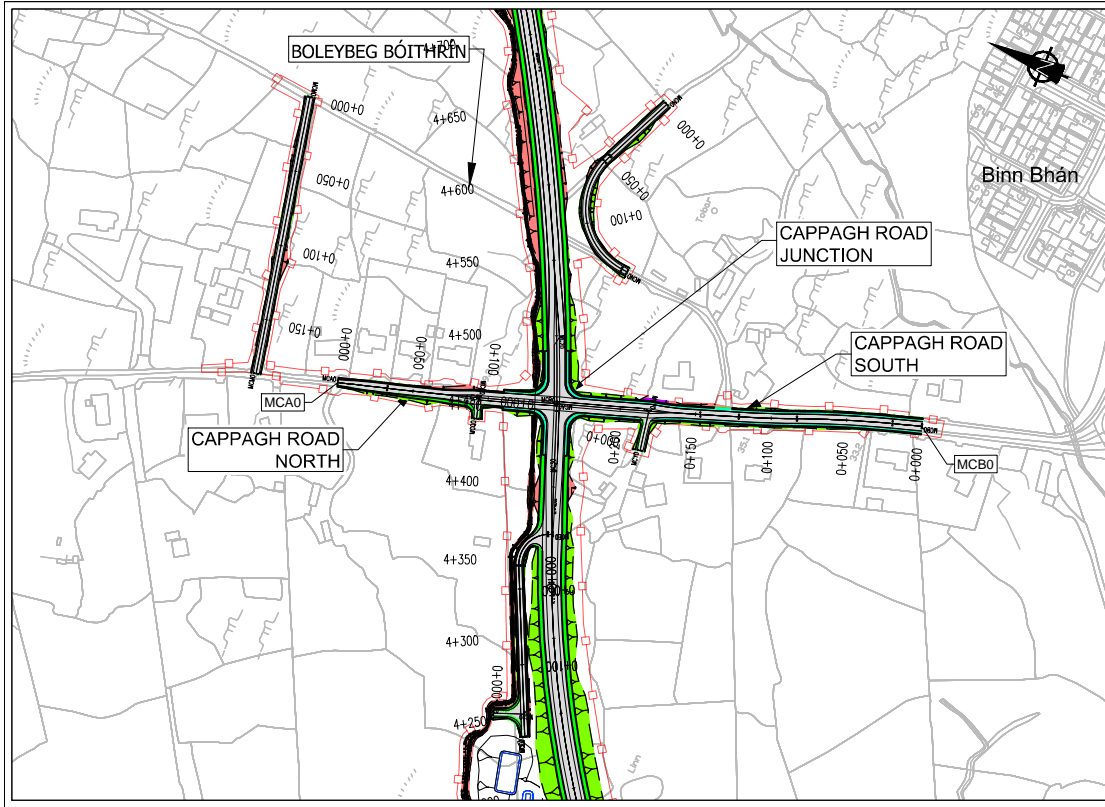

- EIA REPORT**
- Legend:**
- Plan
  - City Boundary
  - Proposed Development Boundary
  - Proposed Road Development
  - Earthworks - Fill
  - Earthworks - Cut
  - Proposed Carriageway Pavement
  - Proposed Grass Verge
  - Proposed Bus Lane
  - Proposed Cycleway
  - Proposed Footpath
  - Proposed Shared Footpath/Cycleway
  - Proposed Traffic Island
  - Structure (S)
  - Proposed Retaining wall (R)
  - Proposed Culvert (C)
  - Proposed Mammal Underpass (C)
  - Proposed Attenuation Pond / Infiltration Basin / Wetlands
  - Proposed Stream Diversion

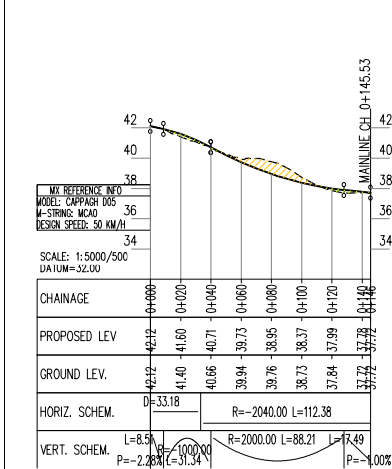

CAPPAGH ROAD NORTH (MCA0)

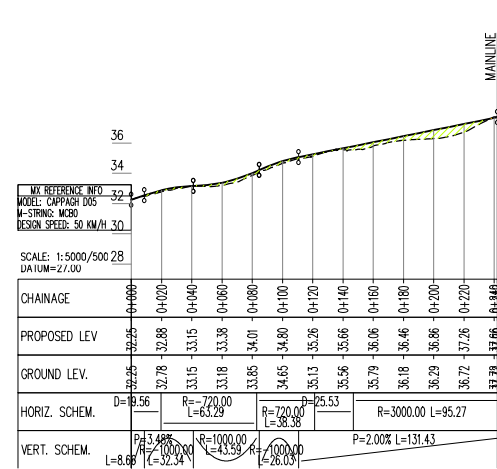

CAPPAGH ROAD SOUTH (MCB0)

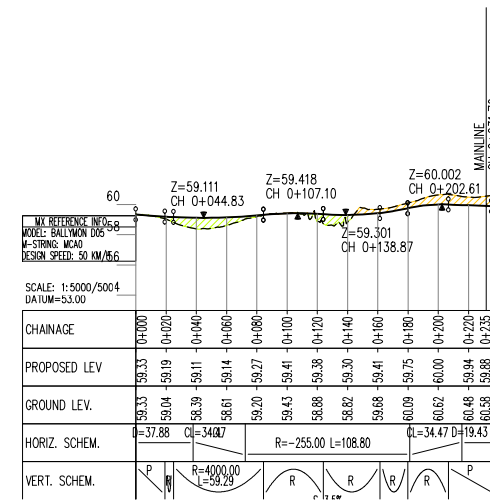

GCR - BALLYMONEEN ROAD NORTH

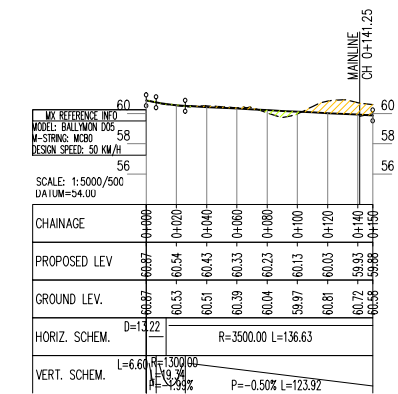

BALLYMONEEN ROAD SOUTH (MCB0)

- Profile**
- Existing Ground
  - Proposed Geometry Profile
  - FILL 15m +
  - FILL 10m - 15m
  - FILL 05m - 10m
  - FILL 00m - 05m
  - CUT 00m - 05m
  - CUT 05m - 10m
  - CUT 10m - 15m
  - CUT 15m +

Sun áiríamh tá sonraíocht Shuirbhéireacht Orlándaís Éireann arna aistriú go dtí físeán OSI Uimh. 2010/20CCMA/Comhairle Contae na Gaillimhe. Sárúilíon aistriú go dtí na h-áiríamh Shuirbhéireacht Orlándaís Éireann agus Rialtas na hÉireann. © Suirbhéireacht Orlándaís Éireann, 2010.

© Suirbhéireacht Orlándaís Éireann. Gach ceart ar chosaint. Uimhir cheadainn 2010/20CCMA/Comhairle Contae na Gaillimhe.

Includes Ordnance Survey Ireland data reproduced under OSI Licence number 2010/20CCMA/Galway County Council. Unauthorised reproduction infringes Ordnance Survey Ireland and Government of Ireland copyright. © Ordnance Survey Ireland, 2010.

© Ordnance Survey Ireland. All rights reserved. Licence number 2010/20CCMA/Galway County Council.

Clients

An Roinn Iompair Turasoireachta agus Spóirt  
Department Transport, Tourism and Sport

Project Ireland 2040  
The Big Ideas for Ireland's Future

Galway City Transport Project

Comhairle Chontae na Gaillimhe  
Galway County Council

TIIV  
Transport Infrastructure Ireland

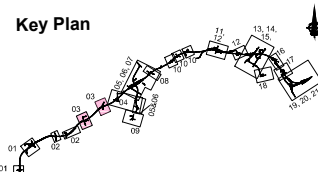

Consultant

**ARUP**

Corporate House  
City East Business Park  
Ballybrit, Galway, Ireland.

Tel +353 (0)91 460675  
www.N6GalwayCity.ie  
www.arup.ie

Job Title  
**N6 Galway City Ring Road**

Scale  
1:2500/250 @ A1; 1:5000/500 @ A3

Date:  
September 2018

Issue	Date	By	Chkd	Appd
13	17/02/2020	KJ	HK	EMC
11	28/09/2018	KJ	MG	EMC

Drawing Title  
**Proposed Road Development Plan & Profile  
Cappagh Road and Ballymoneen Road Roundabouts  
Sheet 3 of 21**

Drawing Status  
**For Information**

Job No  
**233985**

Drawing No  
**Figure 5.3.03**

Issue  
**13**

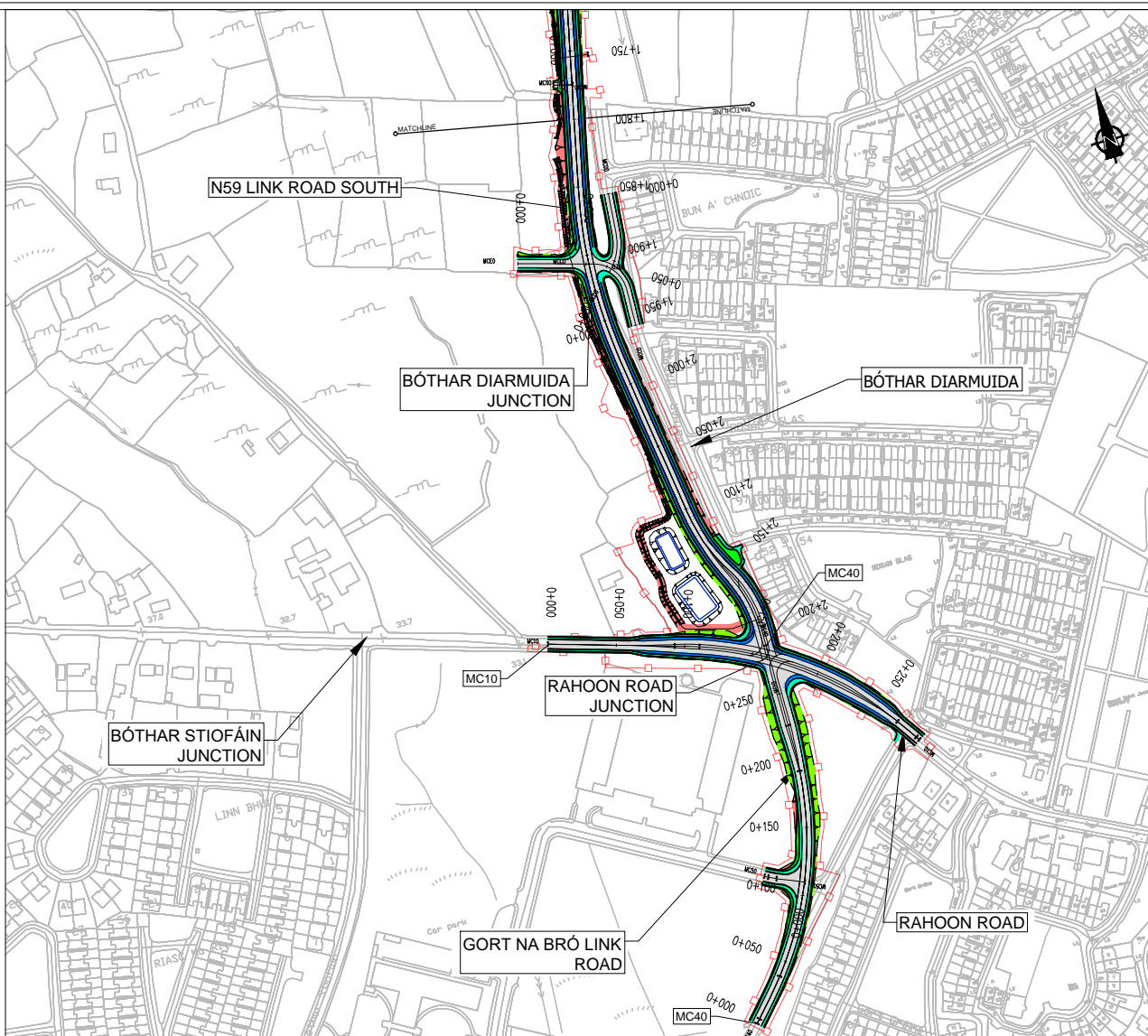
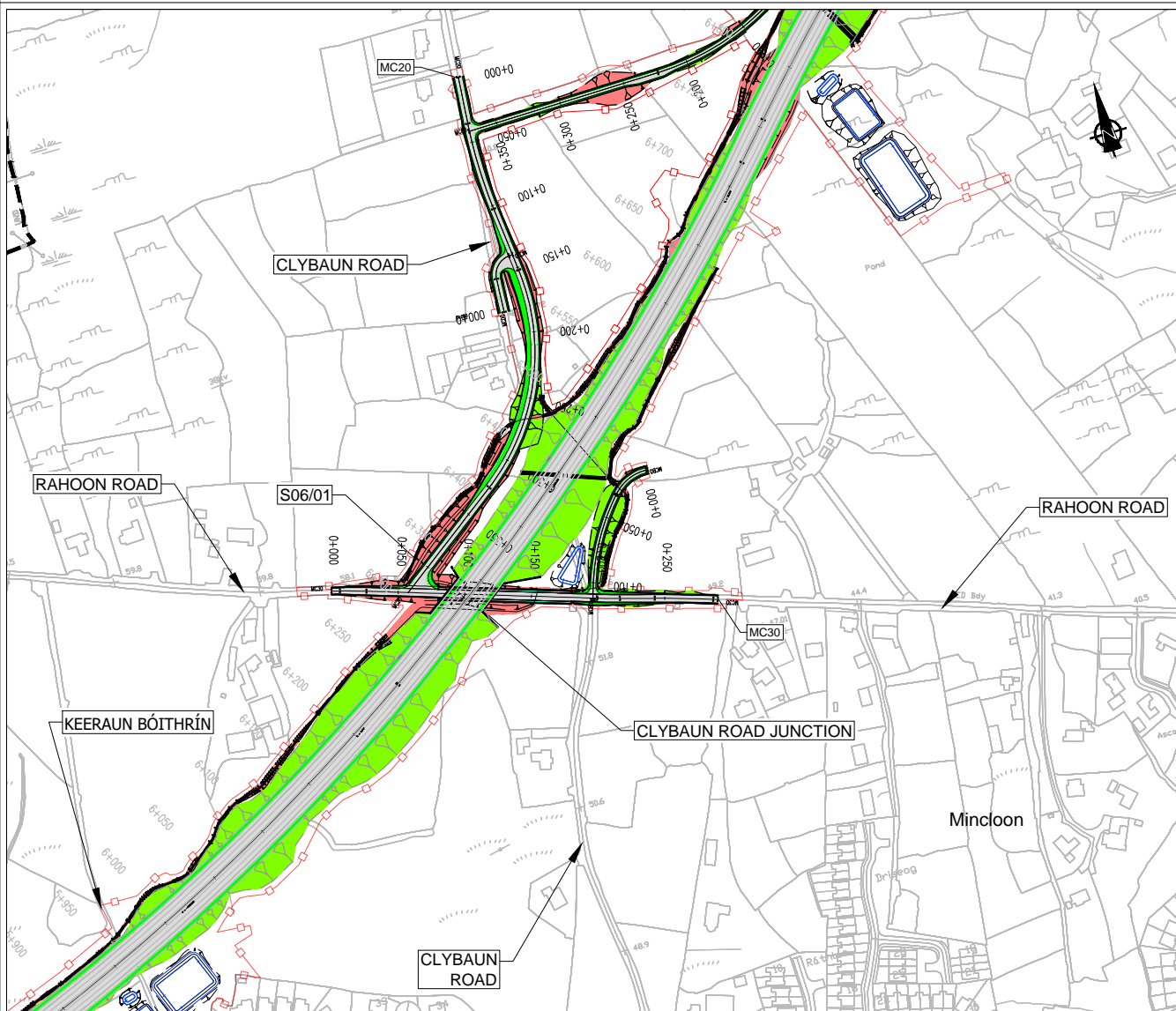

- Legend:**
- Plan
  - City Boundary
  - Proposed Development Boundary
  - Proposed Road Development
  - Earthworks - Fill
  - Earthworks - Cut
  - Proposed Carriageway Pavement
  - Proposed Grass Verge
  - Proposed Bus Lane
  - Proposed Cycleway
  - Proposed Footpath
  - Proposed Shared Footpath/Cycleway
  - Proposed Traffic Island
  - Structure (S)
  - Proposed Retaining wall (R)
  - Proposed Culvert (C)
  - Proposed Mammel Underpass (C)
  - Proposed Attenuation Pond / Infiltration Basin / Wetlands
  - Proposed Stream Diversion

- Profile**
- Existing Ground
  - Proposed Geometry Profile
  - FILL 15m +
  - FILL 10m - 15m
  - FILL 05m - 10m
  - FILL 00m - 05m
  - CUT 00m - 05m
  - CUT 05m - 10m
  - CUT 10m - 15m
  - CUT 15m +

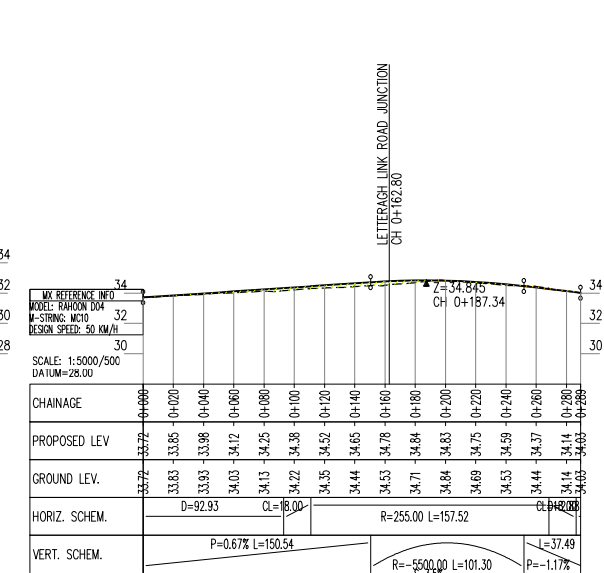
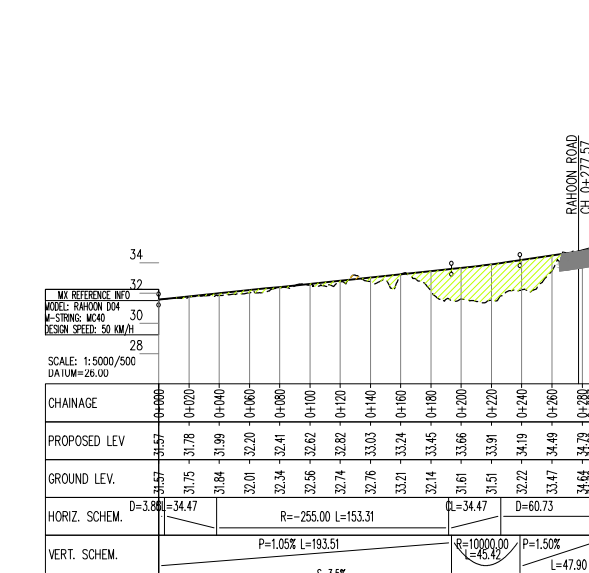
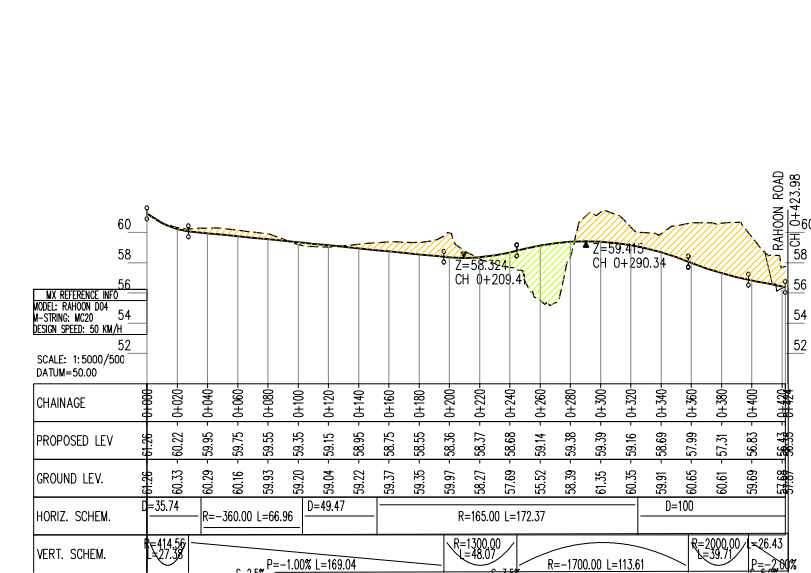
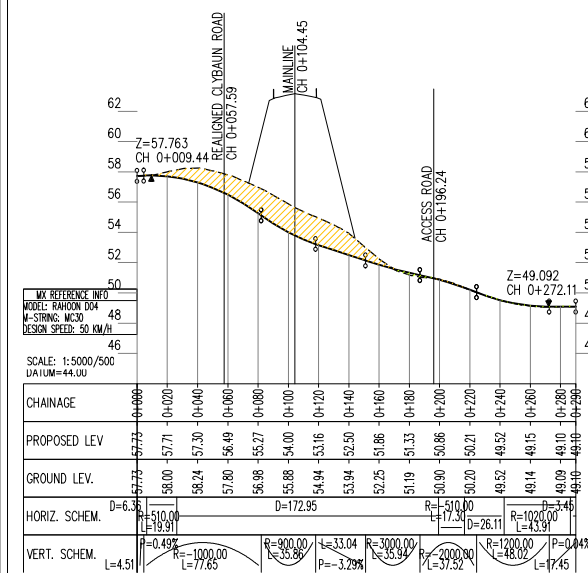

RAHOON ROAD (MC30) (Clybaun Road Junction)

REALIGNED CLYBAUN ROAD (MC20)

GORT NA BRO LINK ROAD (MC40)

RAHOON ROAD (MC10) (Rahoan Road Junction)

Sun áiríamh tá sonraíocht Shuirbhíreacht Orlándaí Éireann arna aistriú go dtí físeán Chaidéas OSI Uimh. 2010/20CCMA/Comhairle Contae na Gaillimhe. Sáráilonn aistriú go dtí físeán cópcheart Shuirbhíreacht Orlándaí Éireann agus Rialtas na hÉireann. © Shuirbhíreacht Orlándaí Éireann, 2010.

© Shuirbhíreacht Orlándaí Éireann. Gach ceart ar chosaint.  
Uimhir cheadainis 2010/20CCMA/Comhairle Contae na Gaillimhe.

Includes Ordnance Survey Ireland data reproduced under OSI Licence number 2010/20CCMA/Galway County Council.  
Unauthorized reproduction infringes Ordnance Survey Ireland and Government of Ireland copyright. © Ordnance Survey Ireland, 2010.

© Ordnance Survey Ireland. All rights reserved. Licence number 2010/20CCMA/Galway County Council.

Clients

An Roinn Iompair  
Turasóireachta agus Spóirt  
Department Transport, Tourism and Sport

Project Ireland 2040  
The National Development Plan

Galway City Transport Project

Comhairle Chontae na Gaillimhe  
Galway County Council

TIU  
Iompartha Iompair Éireann  
Transport Infrastructure Ireland

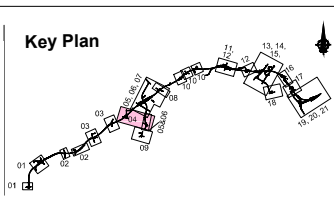

Consultant

**ARUP**

Corporate House  
City East Business Park  
Ballybricit, Galway, Ireland.

Tel +353 (0)91 460675  
www.N6GalwayCity.ie  
www.arup.ie

Job Title  
**N6 Galway City Ring Road**

Scale  
1:2500/250 @ A1; 1:5000/500 @ A3

Date:  
September 2018

Issue	Date	By	Chkd	Appd
13	17/02/2020	KJ	HK	EMC
11	28/09/2018	KJ	MG	EMC

Drawing Title  
**Proposed Road Development Plan & Profile  
Rahoan Road  
Sheet 4 of 21**

Drawing Status  
**For Information**

Job No  
**233985**

Drawing No  
**Figure 5.3.04**

Issue  
**13**

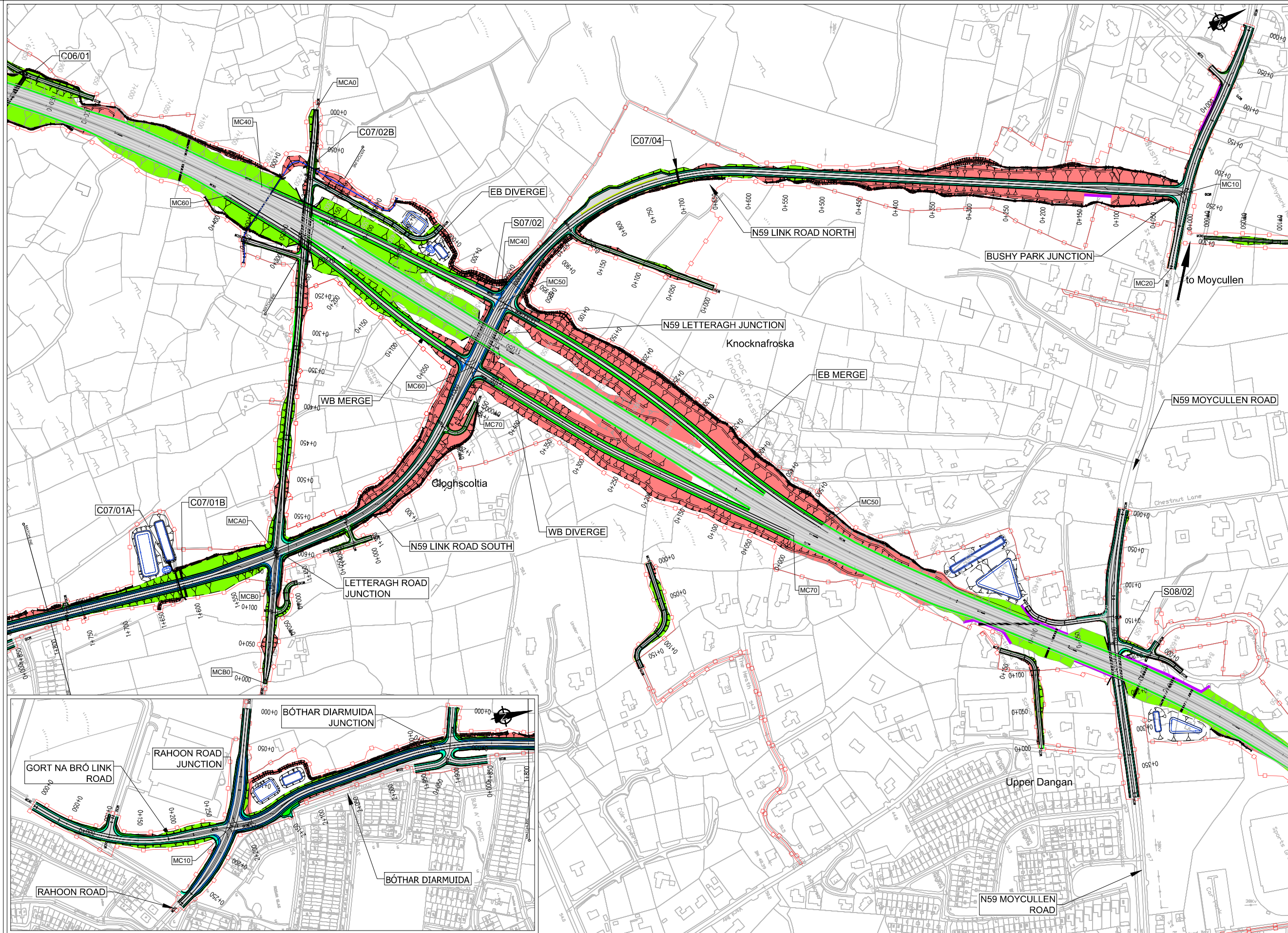

- Legend:**
- Plan
  - City Boundary
  - Proposed Development Boundary
  - Proposed Road Development
  - Earthworks - Fill
  - Earthworks - Cut
  - Proposed Carriageway Pavement
  - Proposed Grass Verge
  - Proposed Bus Lane
  - Proposed Cycleway
  - Proposed Footpath
  - Proposed Shared Footpath/Cycleway
  - Proposed Traffic Island
  - Structure (S)
  - Proposed Retaining wall (R)
  - Proposed Culvert (C)
  - Proposed Mammal Underpass (C)
  - Proposed Attenuation Pond / Infiltration Basin / Wetlands
  - Proposed Stream Diversion

- Profile**
- Existing Ground
  - Proposed Geometry Profile
  - FILL 15m +
  - FILL 10m - 15m
  - FILL 05m - 10m
  - FILL 00m - 05m
  - CUT 00m - 05m
  - CUT 05m - 10m
  - CUT 10m - 15m
  - CUT 15m +

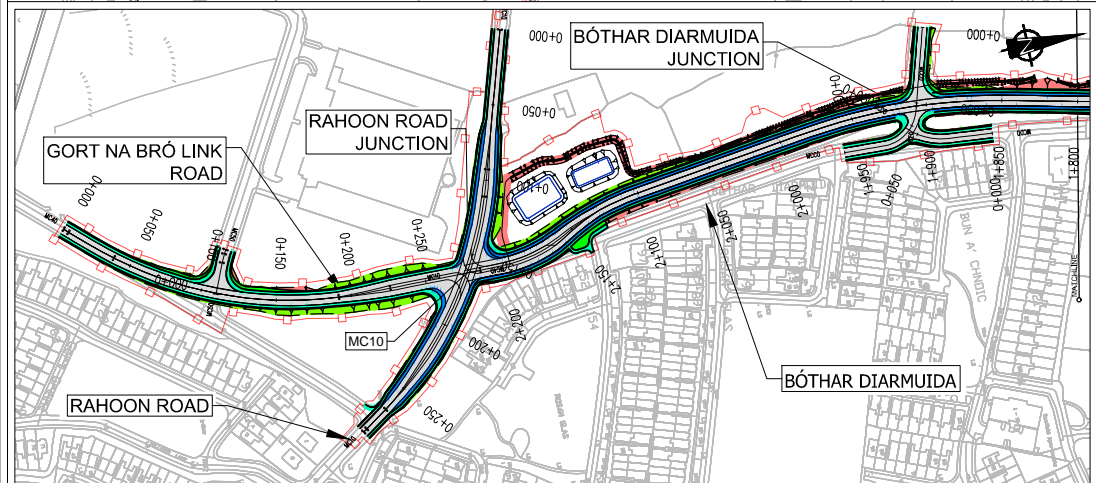

Son áiríamh tá sonraíocht Shuirbhíreacht Orlandais Éireann arna aistriú go dtí físeán Chéadainn OSI Uimh. 2010/20CCMA/Comhairle Contae na Gaillimhe. Sáráilín aistriú go dtí na mbeirteanna na císcheart Shuirbhíreacht Orlandais Éireann agus Rialtas na hÉireann. © Suirbhíreacht Orlandais Éireann, 2010.

© Suirbhíreacht Orlandais Éireann. Gach ceart ar chosaint. Uimhir cheadainn 2010/20CCMA/Comhairle Contae na Gaillimhe.

Includes Ordnance Survey Ireland data reproduced under OSI Licence number 2010/20CCMA/Galway County Council. Unauthorised reproduction infringes Ordnance Survey Ireland and Government of Ireland copyright. © Ordnance Survey Ireland, 2010.

© Ordnance Survey Ireland. All rights reserved. Licence number 2010/20CCMA/Galway County Council.

Clients

An Roinn Iompair Turasoireachta agus Spóirt  
Department Transport, Tourism and Sport

Project Ireland 2040  
The National Development Plan

Galway City Transport Project

Comhairle Chontae na Gaillimhe  
Galway County Council

TIU  
Transport Infrastructure Unit

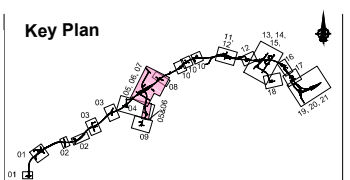

Consultant

**ARUP**

Corporate House  
City East Business Park  
Ballybrit, Galway, Ireland.

Tel +353 (0)91 460675  
www.NEGalwayCity.ie  
www.arup.ie

Job Title  
N6 Galway City Ring Road

Scale  
1:2500/250 @ A1; 1:5000/500 @ A3

Date:  
September 2018

Issue	Date	By	Chkd	Appd
13	17/02/2020	KJ	HK	EMC
11	28/09/2018	KJ	MG	EMC

Drawing Title  
Proposed Road Development Plan & Profile  
N59 Letteragh Junction Plan  
Sheet 5 of 21

Drawing Status  
For Information

Job No  
233985

Drawing No  
Figure 5.3.05

Issue  
13



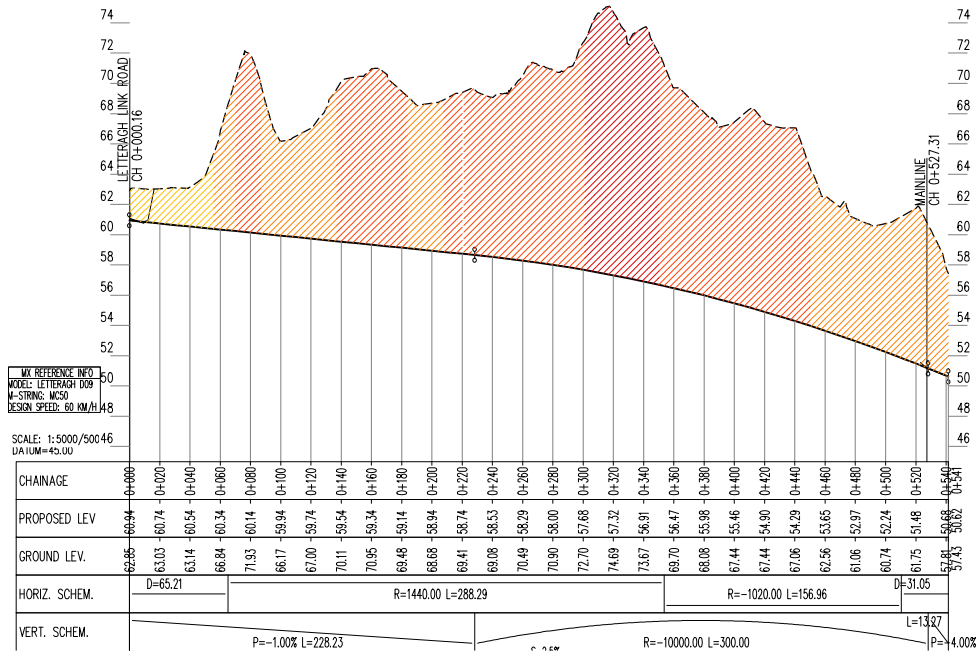

LETTERAGH JUNCTION - EASTBOUND MERGE (MC50)

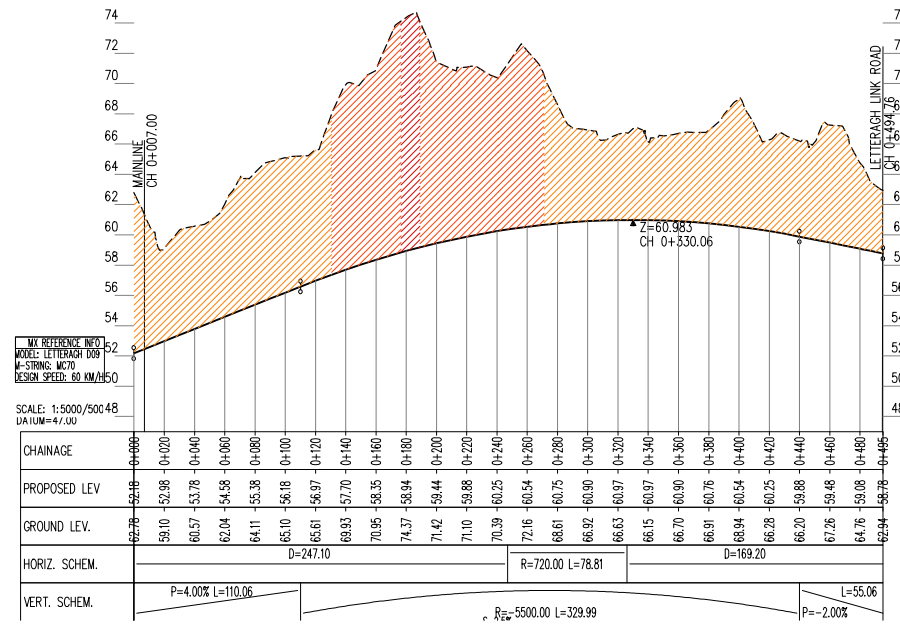

LETTERAGH JUNCTION - WESTBOUND DIVERGE (MC70)

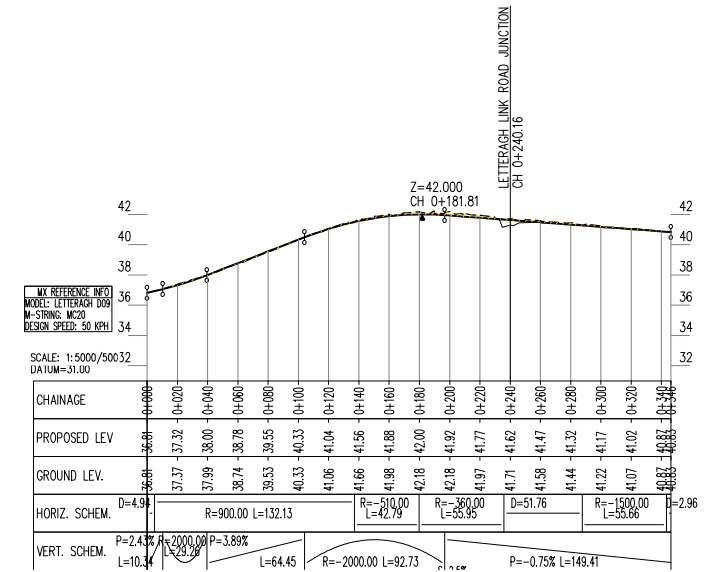

N59 MOYCULLEN ROAD (MC20)

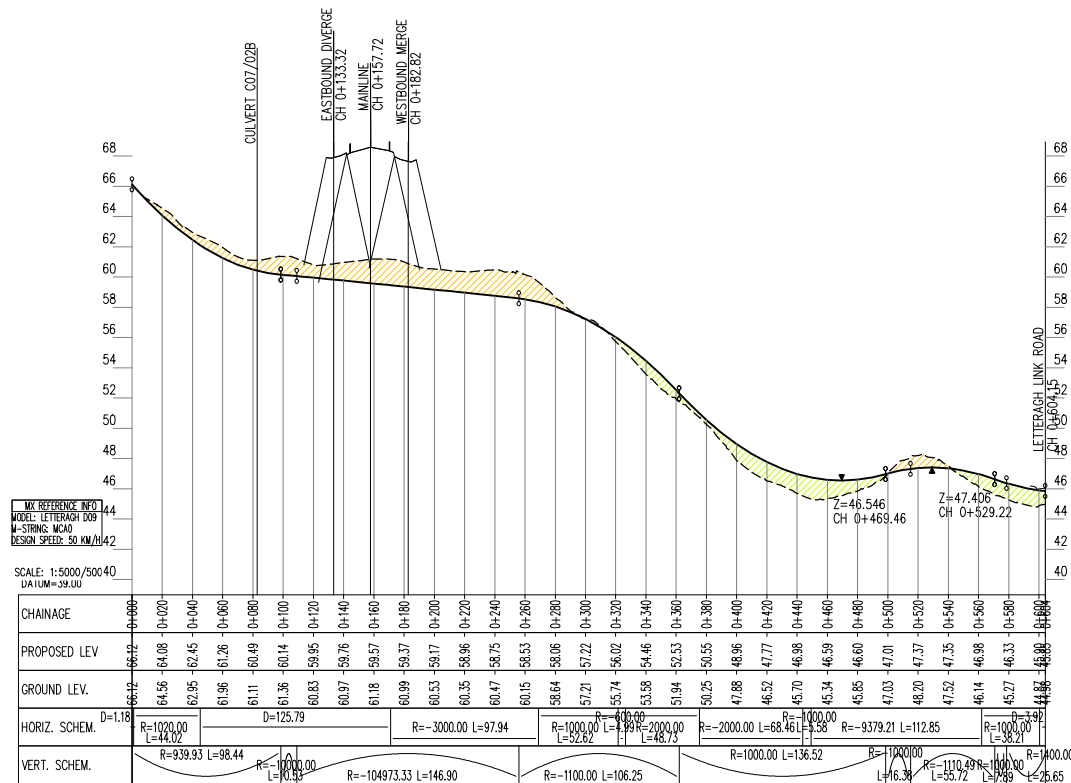
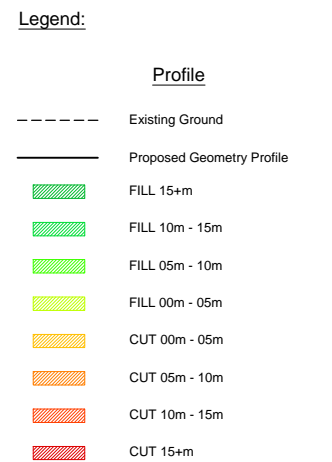

LETTERAGH ROAD WEST (MCA0)

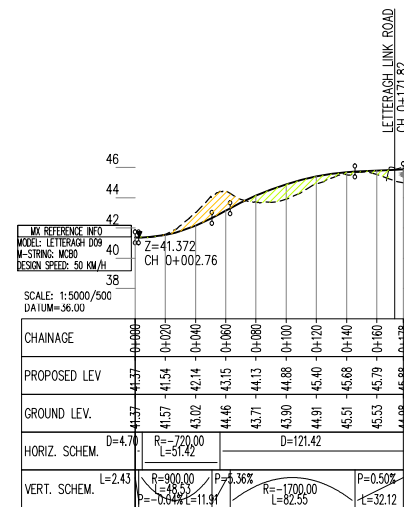

LETTERAGH ROAD EAST (MCB0)

San áiríamh tá sonraíocht Shuirbhíreacht Orlándaí Éireann arna aistriú go dtí físeán OSI Uimh. 2010/20CCMA/Comhairle Contae na Gaillimhe. Sárúil ar aistriú go dtí neamháiríocht cíoscheart Shuirbhíreacht Orlándaí Éireann agus Rialtas na hÉireann. © Suirbhíreacht Orlándaí Éireann, 2010.

© Suirbhíreacht Orlándaí Éireann. Gach ceart ar chosaint. Uimhir cheadainn 2010/20CCMA/Comhairle Contae na Gaillimhe.

Includes Ordnance Survey Ireland data reproduced under OSI Licence number 2010/20CCMA/Galway County Council. Unauthorised reproduction infringes Ordnance Survey Ireland and Government of Ireland copyright. © Ordnance Survey Ireland, 2010.

© Ordnance Survey Ireland. All rights reserved. Licence number 2010/20CCMA/Galway County Council.

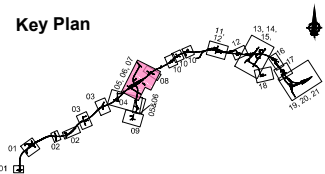

Job Title: N6 Galway City Ring Road

Scale	1:2500/250 @ A1; 1:5000/500 @ A3
Date:	June 2019

Issue	Date	By	Chkd	Appd
I3	17/02/2020	KJ	HK	EMC
I2	14/06/2019	CW	MG	EMC
I1	28/09/2018	KJ	MG	EMC

Drawing Title: Proposed Road Development Plan & Profile N59 Letteragh Junction Profiles Sheet 7 of 21

Drawing Status: For Information

Job No	233985	Drawing No	Figure 5.3.07	Issue	I3
--------	--------	------------	---------------	-------	----

Legend:

- Plan**
- City Boundary
  - Proposed Development Boundary
  - Proposed Road Development
  - Earthworks - Fill
  - Earthworks - Cut
  - Proposed Carriageway Pavement
  - Proposed Grass Verge
  - Proposed Bus Lane
  - Proposed Cycleway
  - Proposed Footpath
  - Proposed Shared Footpath/Cycleway
  - Proposed Traffic Island
  - Structure (S)
  - Proposed Retaining wall (R)
  - Proposed Culvert (C)
  - Proposed Mammal Underpass (C)
  - Proposed Attenuation Pond / Infiltration Basin / Wetlands
  - Proposed Stream Diversion

**Profile**

- Existing Ground
- Proposed Geometry Profile
- FILL 15m +
- FILL 10m - 15m
- FILL 05m - 10m
- FILL 00m - 05m
- CUT 00m - 05m
- CUT 05m - 10m
- CUT 10m - 15m
- CUT 15m +

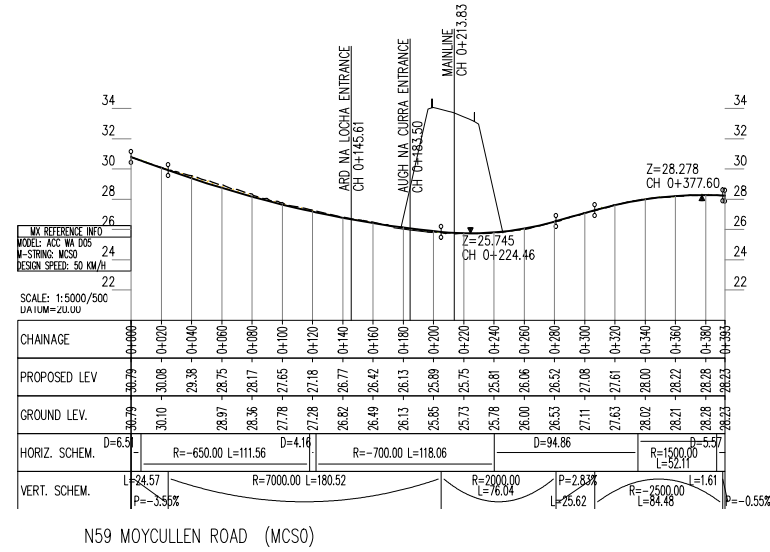
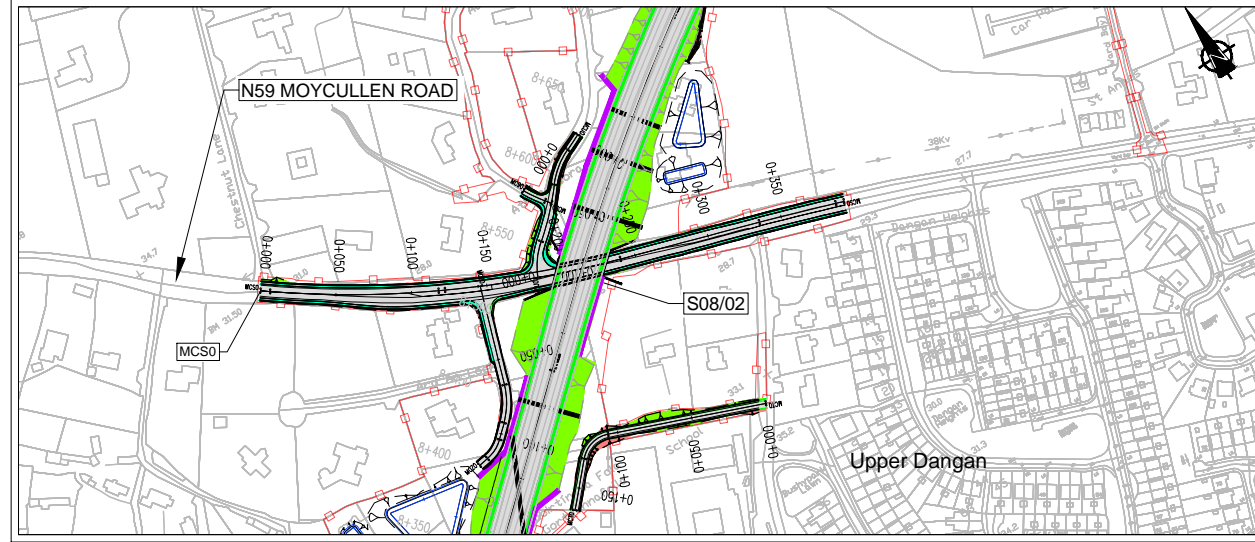

Sun áiríúmh tá sonraíocht Shairbhéireacht Orlánáis Éireann arna aistriúgeadh fíor Cheadúnas OSI Uimh. 2010/20CCMA/Comhairle Contae na Gaillimhe. Sárúisinn aistriúgeadh neamhdáraithe cóipeacht Shairbhéireacht Orlánáis Éireann agus Rialtas na hÉireann. © Sairbhéireacht Orlánáis Éireann, 2010.

© Sairbhéireacht Orlánáis Éireann. Gach ceart ar chosaint. Uimhir cheadúnais 2010/20CCMA/Comhairle Contae na Gaillimhe.

Includes Ordnance Survey Ireland data reproduced under OSI Licence number 2010/20CCMA/Galway County Council. Unauthorised reproduction infringes Ordnance Survey Ireland and Government of Ireland copyright. © Ordnance Survey Ireland, 2010.

© Ordnance Survey Ireland. All rights reserved. Licence number 2010/20CCMA/Galway County Council.

Clients

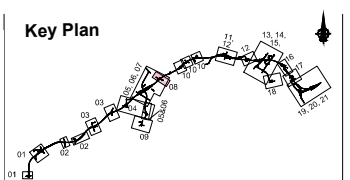

Consultant

Corporate House  
City East Business Park  
Ballybrit, Galway, Ireland.

Tel +353 (0)91 460675  
www.N6GalwayCity.ie  
www.arup.ie

Job Title  
**N6 Galway City Ring Road**

Scale  
1:2500/250 @ A1; 1:5000/500 @ A3

Date:  
September 2018

Issue	Date	By	Chkd	Appd
13	17/02/2020	KJ	HK	EMC
11	28/09/2018	KJ	MG	EMC

Drawing Title  
**Proposed Road Development Plan & Profile  
Realigned N59 Moycullen Road, NUIG Access Road**

Sheet 8 of 21

Drawing Status  
**For Information**

Job No  
**233985**

Drawing No  
**Figure 5.3.08**

Issue  
**13**



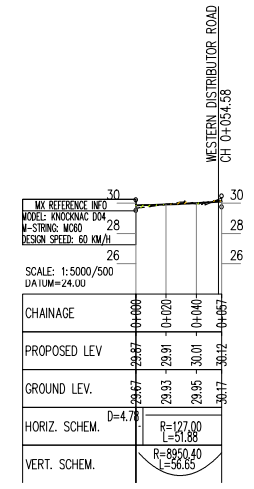
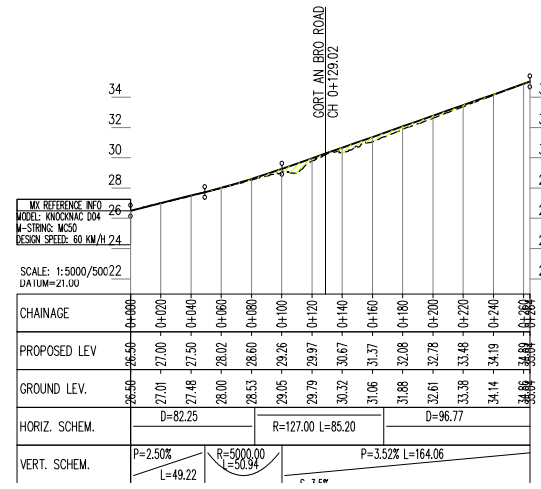
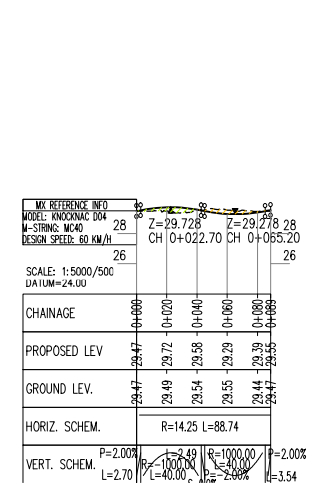
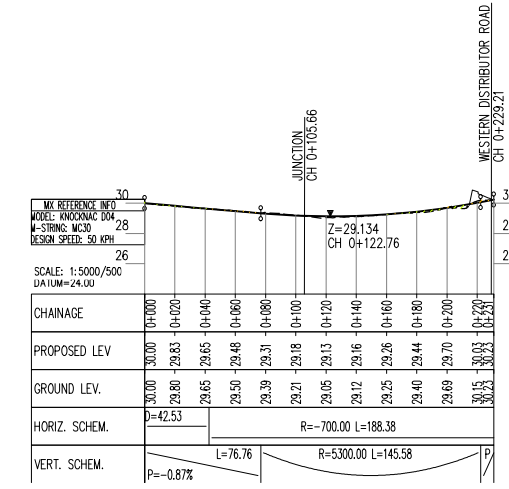
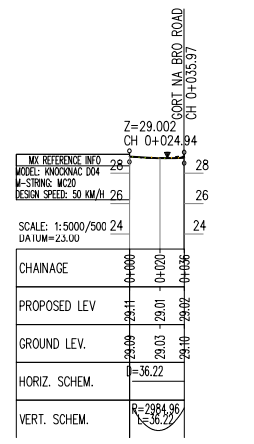
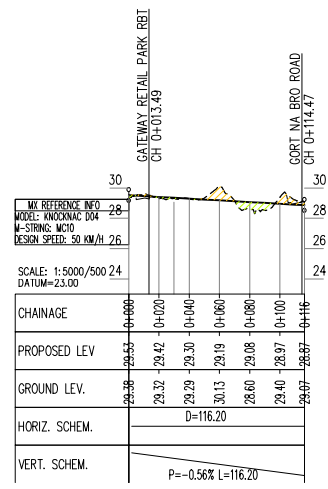
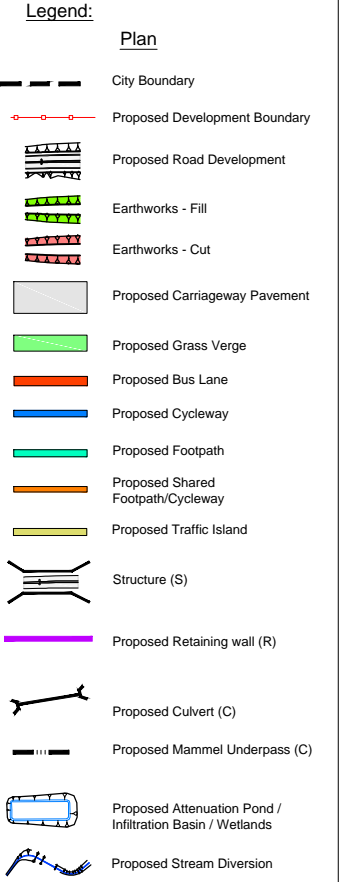
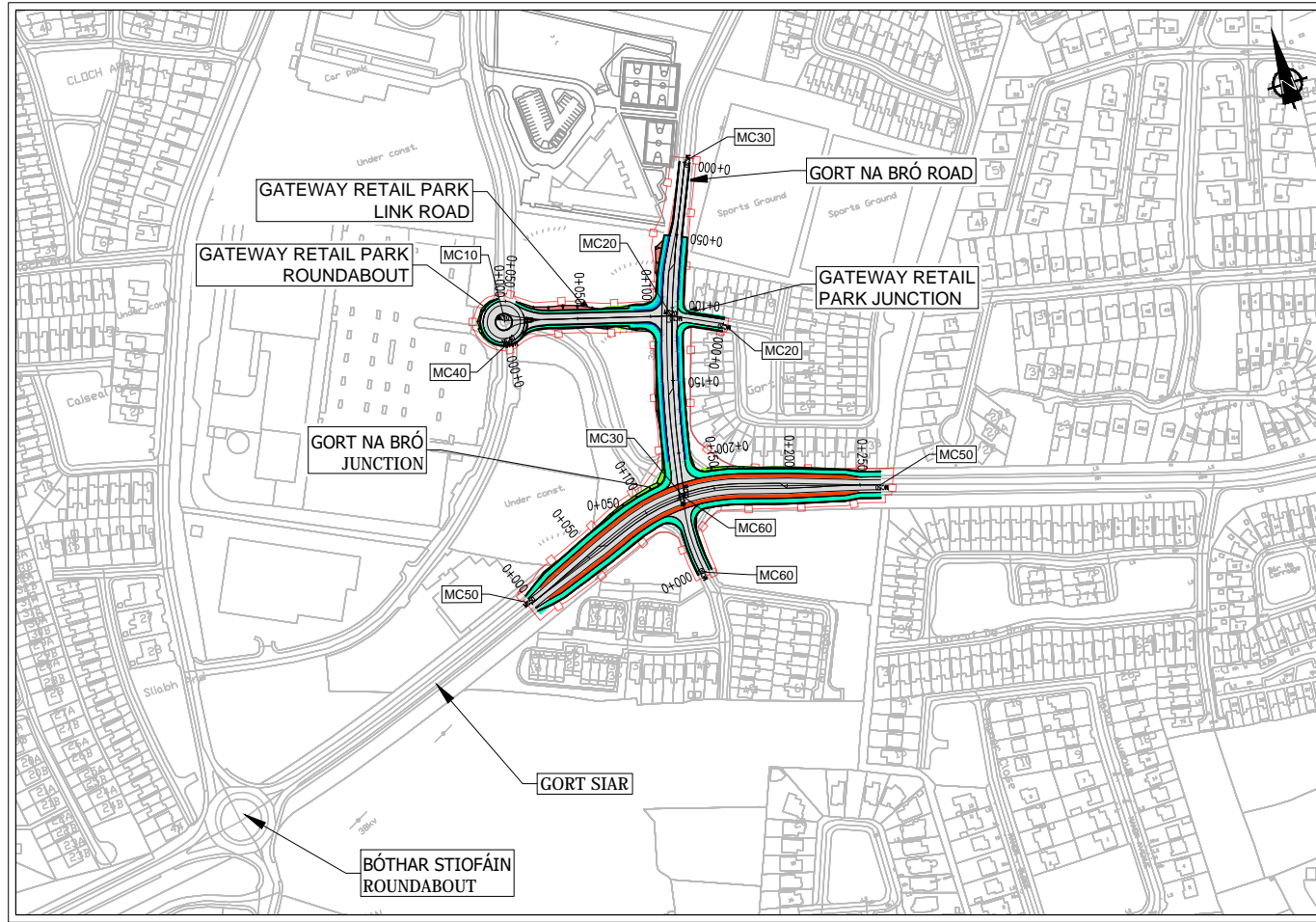

Son áiríamh tá sonraíocht Shuirbhíreacht Orlándaí Éireann arna áirígeadh fíor Cheadúnas OSI Uimh. 2010/20CCMA/Comhairle Contae na Gaillimhe. Sárúinn áirígeadh neamhdáraithe cóipeacht Shuirbhíreacht Orlándaí Éireann agus Rialtas na hÉireann. © Suirbhíreacht Orlándaí Éireann, 2010.

© Suirbhíreacht Orlándaí Éireann. Gach ceart ar chosaint.  
 Uimhir cheadúnais 2010/20CCMA/Comhairle Contae na Gaillimhe.

Includes Ordnance Survey Ireland data reproduced under OSI Licence number 2010/20CCMA/Galway County Council.  
 Unauthorised reproduction infringes Ordnance Survey Ireland and Government of Ireland copyright. © Ordnance Survey Ireland, 2010.

© Ordnance Survey Ireland. All rights reserved. Licence number 2010/20CCMA/Galway County Council.

Clients

An Roinn Iompair  
 Turasoireachta agus Spóirt  
 Department Transport, Tourism and Sport

Project Ireland 2040  
 The Big Ideas  
 Future

Galway City Transport Project

Comhairle Chontae na Gaillimhe  
 Galway County Council

TIU  
 Transport Infrastructure Unit

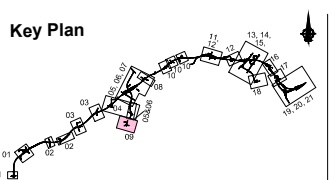

Consultant

**ARUP**

Corporate House  
 City East Business Park  
 Ballybrit, Galway, Ireland.

Tel +353 (0)91 460675  
 www.N6GalwayCity.ie  
 www.arup.ie

Job Title  
**N6 Galway City Ring Road**

Scale  
 1:2500/250 @ A1; 1:5000/500 @ A3

Date:  
 September 2018

Issue	Date	By	Chkd	Appd
13	17/02/2020	KJ	HK	EMC
11	28/09/2018	KJ	MG	EMC

Drawing Title  
**Proposed Road Development Plan & Profile  
 Gateway Retail Park, Gort na Bro**

Sheet 9 of 21

Drawing Status  
**For Information**

Job No  
**233985**

Drawing No  
**Figure 5.3.09**

Issue  
**13**

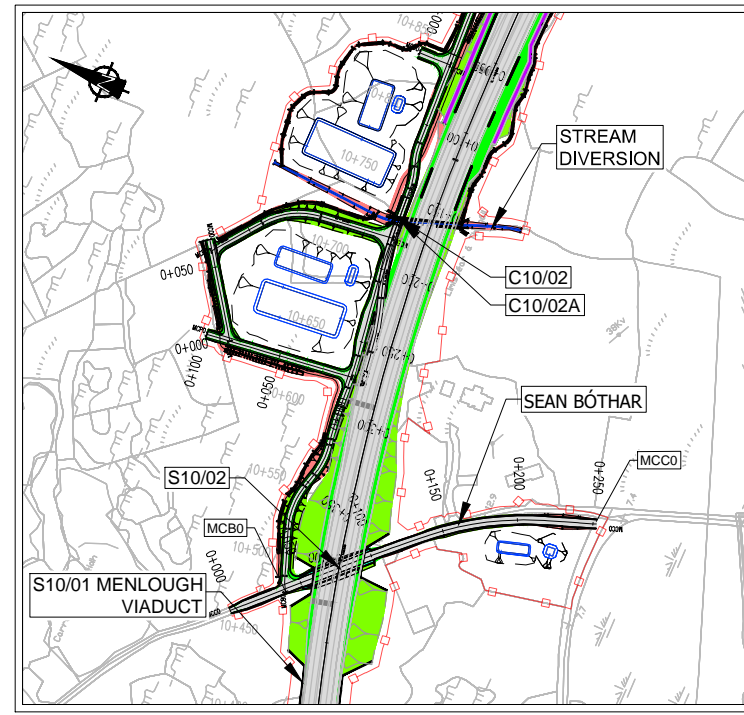
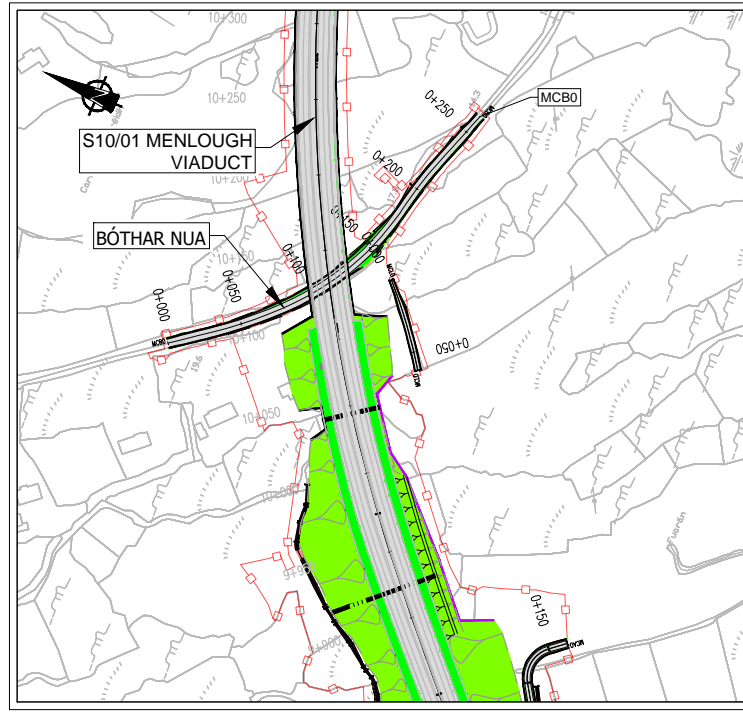
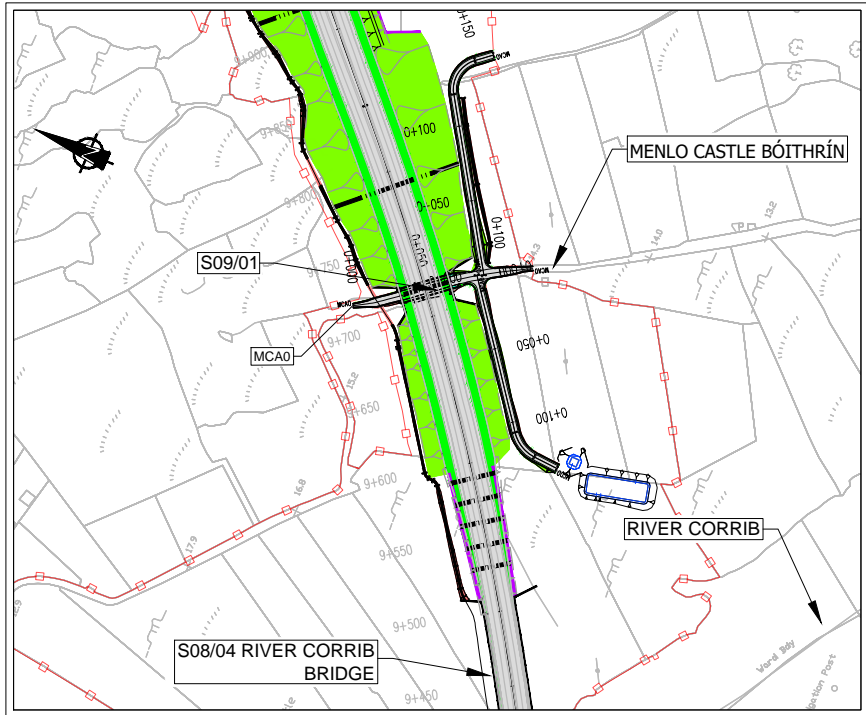

- Legend:**
- Plan
  - City Boundary
  - Proposed Development Boundary
  - Proposed Road Development
  - Earthworks - Fill
  - Earthworks - Cut
  - Proposed Carriageway Pavement
  - Proposed Grass Verge
  - Proposed Bus Lane
  - Proposed Cycleway
  - Proposed Footpath
  - Proposed Shared Footpath/Cycleway
  - Proposed Traffic Island
  - Structure (S)
  - Proposed Retaining wall (R)
  - Proposed Culvert (C)
  - Proposed Mammal Underpass (C)
  - Proposed Attenuation Pond / Infiltration Basin / Wetlands
  - Proposed Stream Diversion

- Profile**
- Existing Ground
  - Proposed Geometry Profile
  - FILL 15m +
  - FILL 10m - 15m
  - FILL 05m - 10m
  - FILL 00m - 05m
  - CUT 00m - 05m
  - CUT 05m - 10m
  - CUT 10m - 15m
  - CUT 15m +

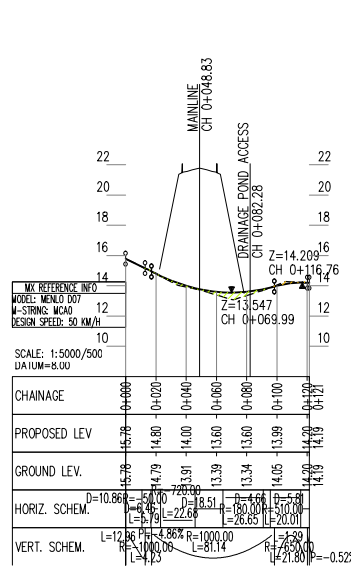

MENLO CASTLE BÓITHRÍN (MCA0)

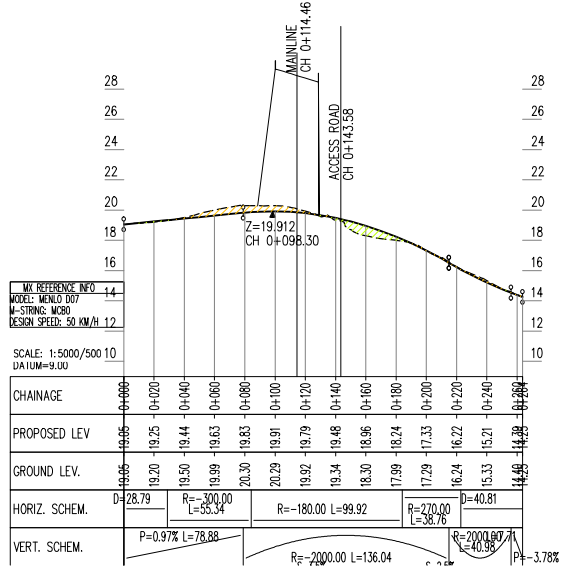

BÓTHAR NUA (MCB0)

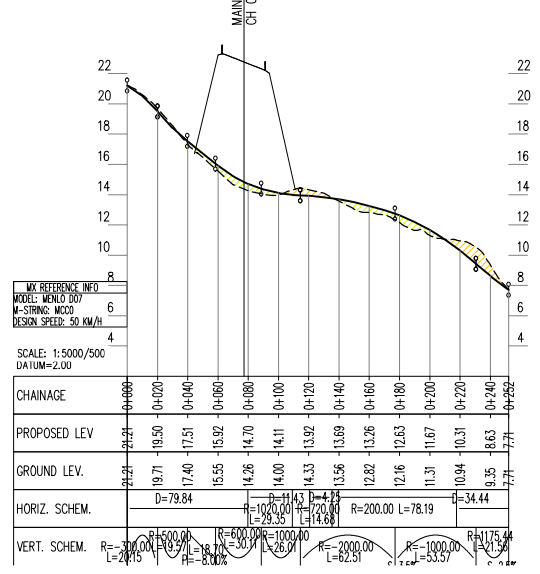

SEAN BÓTHAR (MCC0)

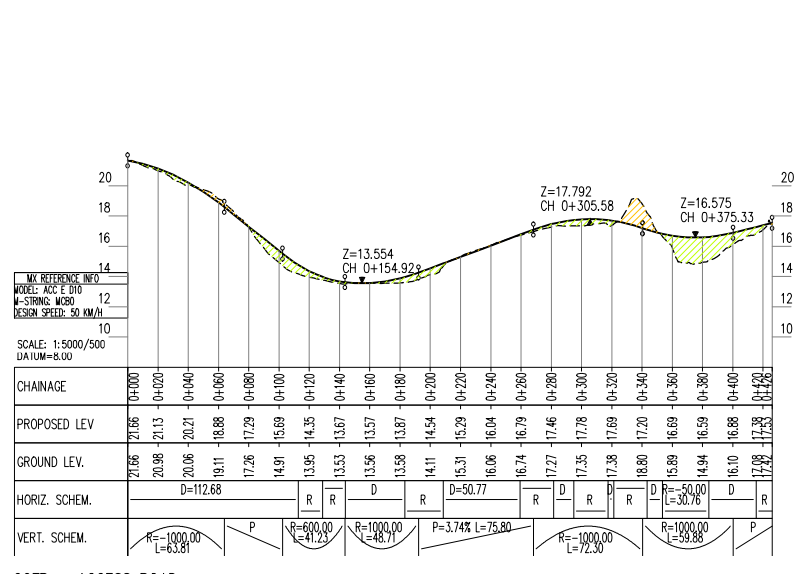

GCTP - ACCESS ROAD

Sun áiríonn sé sonraíocht Shairbhíreacht Orlándaí Éireann arna aistriúchán fíúil Cheadúnas OSI Uimh. 2010/20CCMA/Comhairle Contae na Gaillimhe. Sárúinn aistriúchán neamhdáraithe cóipeacht Shairbhíreacht Orlándaí Éireann agus Rialtas na hÉireann. © Sairbhíreacht Orlándaí Éireann, 2010.

© Sairbhíreacht Orlándaí Éireann. Gach ceart ar chosaint. Uimhir cheadúnais 2010/20CCMA/Comhairle Contae na Gaillimhe.

Includes Ordnance Survey Ireland data reproduced under OSI Licence number 2010/20CCMA/Galway County Council. Unauthorised reproduction infringes Ordnance Survey Ireland and Government of Ireland copyright. © Ordnance Survey Ireland, 2010.

© Ordnance Survey Ireland. All rights reserved. Licence number 2010/20CCMA/Galway County Council.

Clients

An Roinn Iompair  
Turasóireacht agus Spóirt  
Department Transport, Tourism and Sport

Project Ireland 2040  
The Republic of Ireland's  
National Development Plan

Galway City Transport Project

Comhairle Chontae na Gaillimhe  
Galway County Council

TIU  
Iompar agus Spóirt Éireann  
Transport and Tourism Ireland

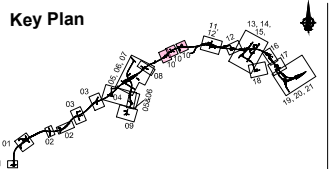

Consultant

**ARUP**

Corporate House  
Ballybrit, Galway, Ireland.

Tel +353 (0)91 460675  
www.N6GalwayCity.ie  
www.arup.ie

Job Title  
**N6 Galway City Ring Road**

Scale  
1:2500/250 @ A1; 1:5000/500 @ A3

Date:  
June 2019

Issue	Date	By	Chkd	Appd
I3	17/02/2020	KJ	HK	EMC
I2	19/06/2019	CW	MG	EMC
I1	28/09/2018	KJ	MG	EMC

Drawing Title  
**Proposed Road Development Plan & Profile  
Menlo Castle Bóithrín, Bóthar Nua, Sean Bóthar**

Drawing Status  
**For Information**

Job No  
**233985**

Drawing No  
**Figure 5.3.10**

Issue  
**13**

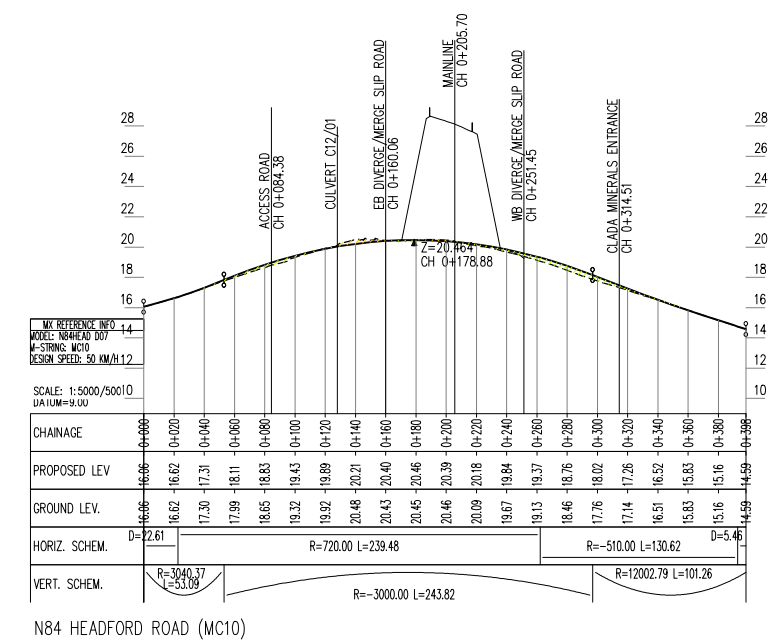
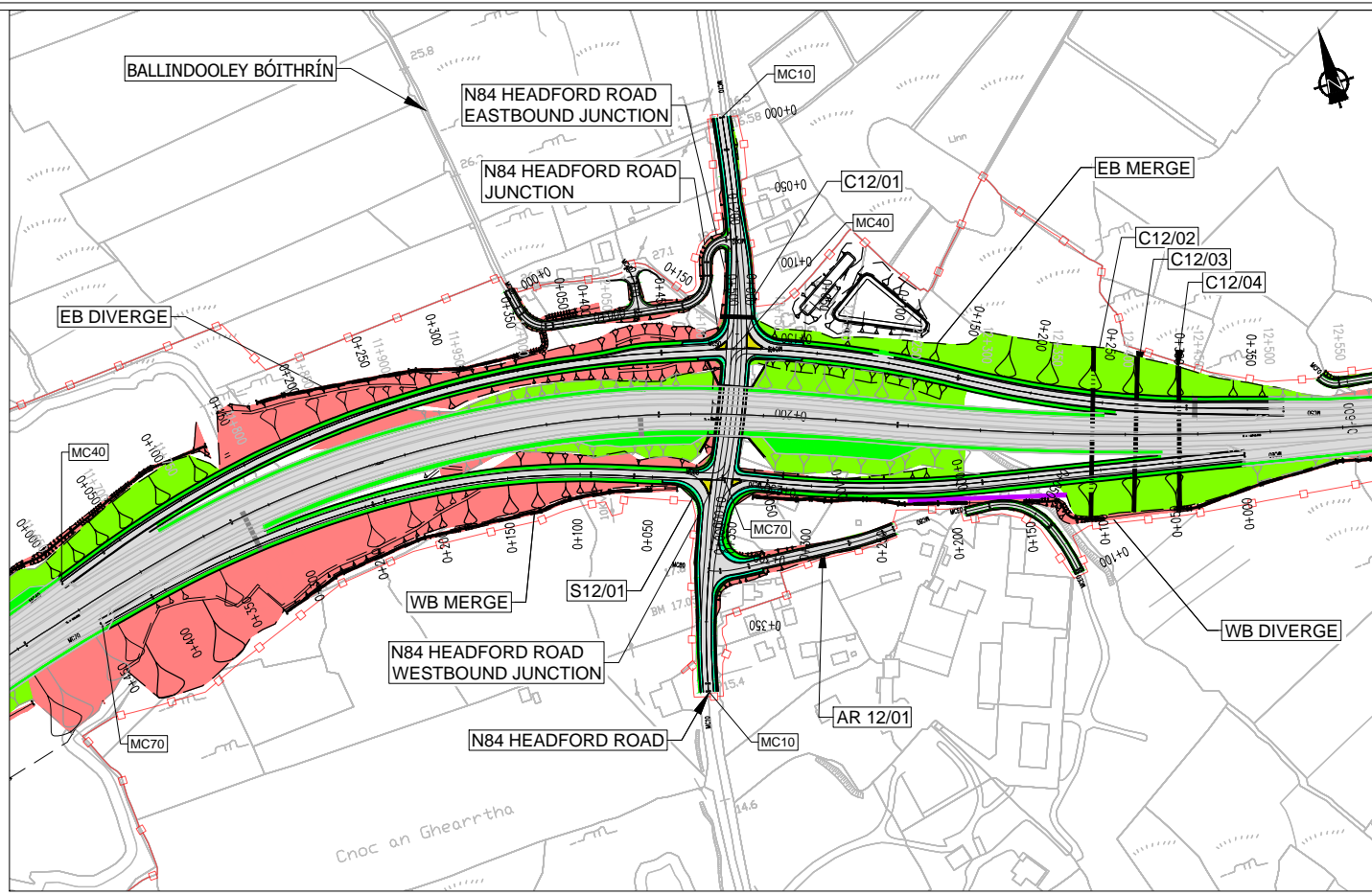

- Legend:**
- City Boundary
  - Proposed Development Boundary
  - Proposed Road Development
  - Earthworks - Fill
  - Earthworks - Cut
  - Proposed Carriageway Pavement
  - Proposed Grass Verge
  - Proposed Bus Lane
  - Proposed Cycleway
  - Proposed Footpath
  - Proposed Shared Footpath/Cycleway
  - Proposed Traffic Island
  - Structure (S)
  - Proposed Retaining wall (R)
  - Proposed Culvert (C)
  - Proposed Mammal Underpass (C)
  - Proposed Attenuation Pond / Infiltration Basin / Wetlands
  - Proposed Stream Diversion
- Profile**
- Existing Ground
  - Proposed Geometry Profile
  - FILL 15m +
  - FILL 10m - 15m
  - FILL 05m - 10m
  - FILL 00m - 05m
  - CUT 00m - 05m
  - CUT 05m - 10m
  - CUT 10m - 15m
  - CUT 15m +

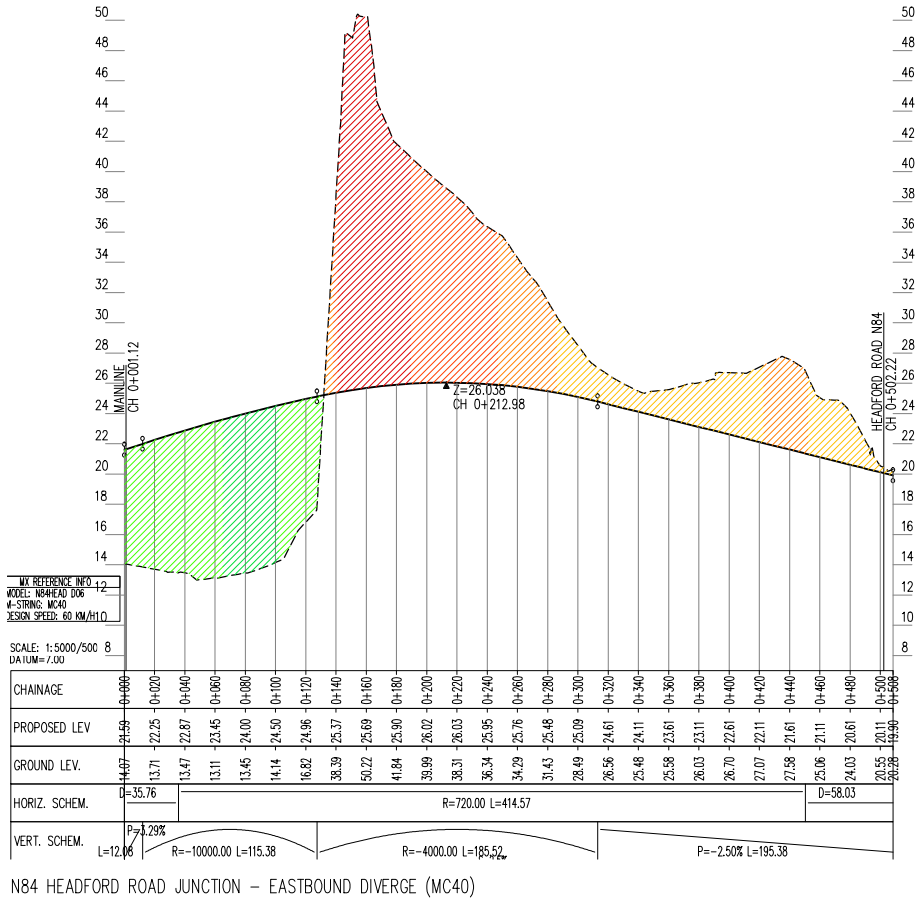

N84 HEADFORD ROAD JUNCTION - EASTBOUND DIVERGE (MC40)

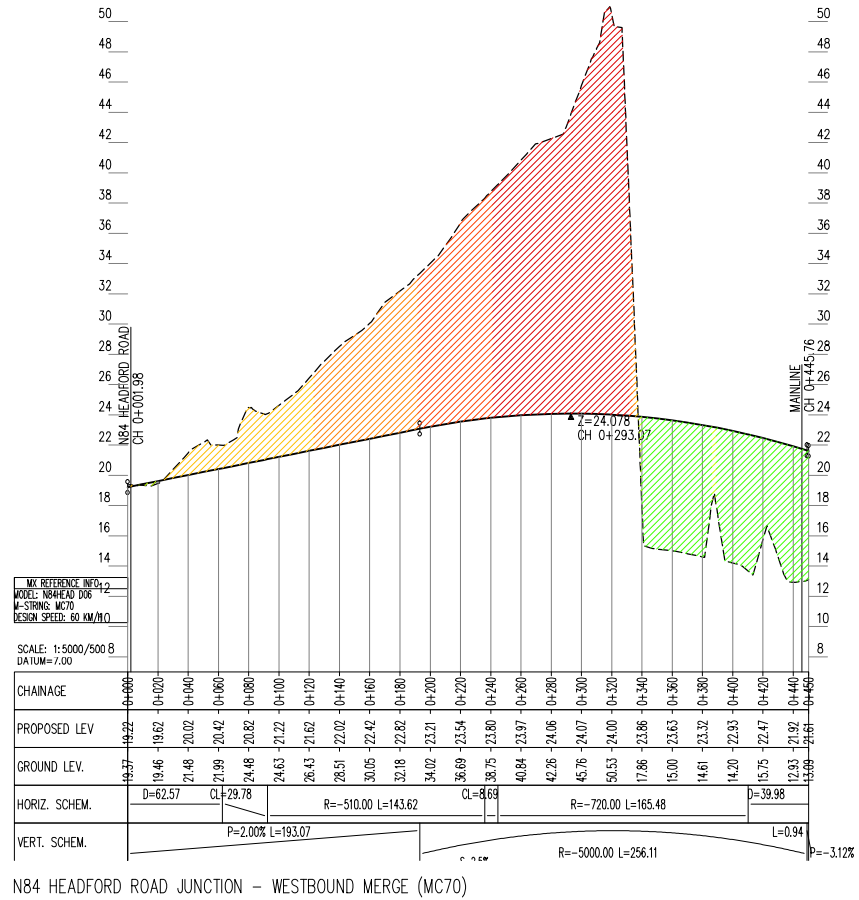

N84 HEADFORD ROAD JUNCTION - WESTBOUND MERGE (MC70)

Sun áiríonn sé sonraíocht Shairbhíreacht Orlánda Éireann arna aistriú go dtí físeán OSi Uimh. 2010/20CCMA/Comhairle Contae na Gaillimhe. Sárúil ar aistriú na n-ábharthaíocht císcheart Shairbhíreacht Orlánda Éireann agus Rialtas na hÉireann. © Shairbhíreacht Orlánda Éireann, 2010.

© Sairbhíreacht Orlánda Éireann. Gach ceart ar chosaint. Uimhir cheadainn 2010/20CCMA/Comhairle Contae na Gaillimhe.

Includes Ordnance Survey Ireland data reproduced under OSI Licence number 2010/20CCMA/Galway County Council. Unauthorised reproduction infringes Ordnance Survey Ireland and Government of Ireland copyright. © Ordnance Survey Ireland, 2010.

© Ordnance Survey Ireland. All rights reserved. Licence number 2010/20CCMA/Galway County Council.

Clients

An Roinn Iompair Turasoíreachta agus Spóirt  
Department Transport, Tourism and Sport

Project Ireland 2040  
The National Development Plan

Galway City Transport Project

Comhairle Chontae na Gaillimhe  
Galway County Council

TIU  
Transport Infrastructure Unit

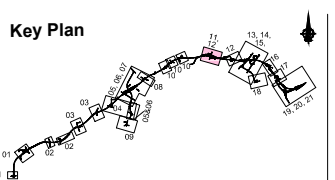

Consultant

**ARUP**

Corporate House  
City East Business Park  
Ballybriff, Galway, Ireland.

Tel +353 (0)91 460675  
www.n6galwaycity.ie  
www.arup.ie

Job Title  
**N6 Galway City Ring Road**

Scale  
1:2500/250 @ A1; 1:5000/500 @ A3

Date:  
September 2018

Issue	Date	By	Chkd	Appd
13	17/02/2020	KJ	HK	EMC
11	28/09/2018	KJ	MG	EMC

For Information

Job No	Drawing No	Issue
233985	Figure 5.3.11	13

Drawing Title  
**Proposed Road Development Plan & Profile  
Headford Road Junction  
Sheet 11 of 21**

Drawing Status  
**For Information**

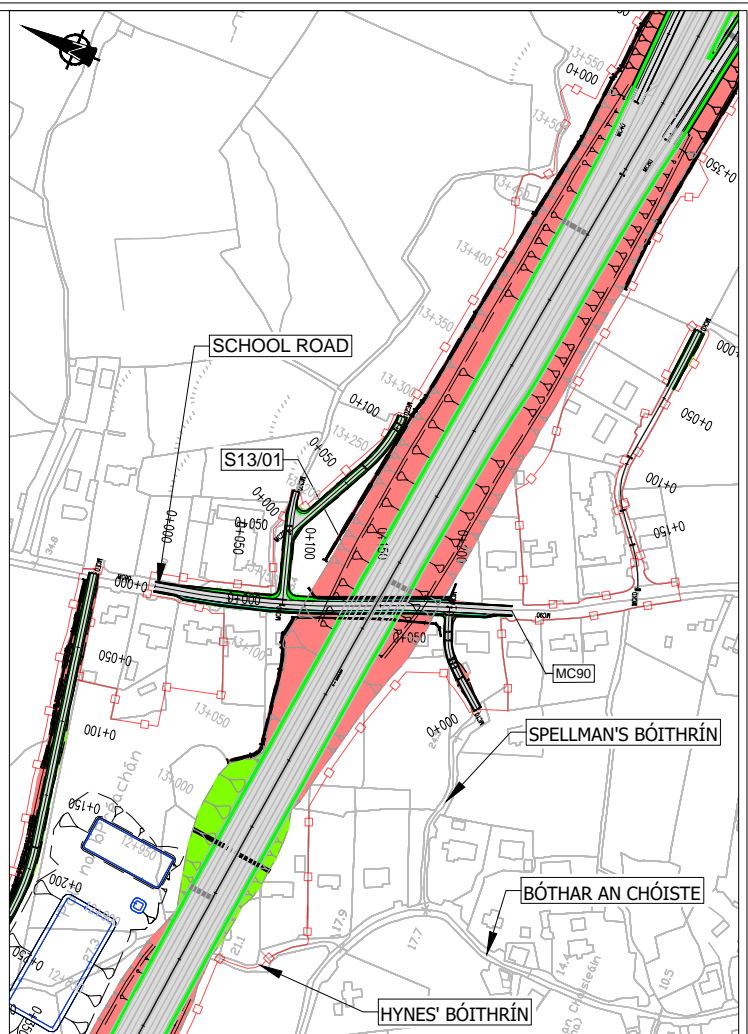
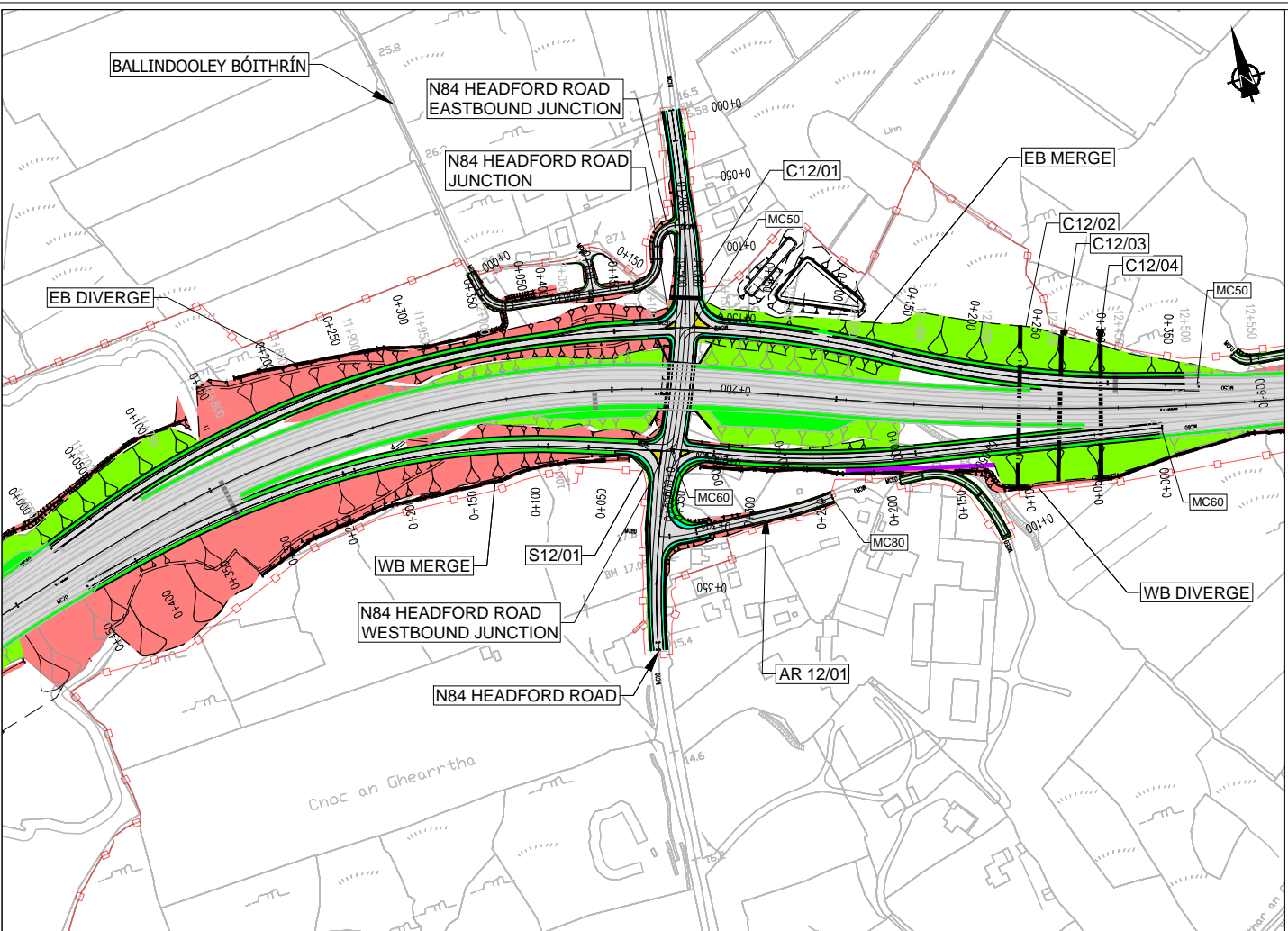

- Legend:**
- Plan
  - City Boundary
  - Proposed Development Boundary
  - Proposed Road Development
  - Earthworks - Fill
  - Earthworks - Cut
  - Proposed Carriageway Pavement
  - Proposed Grass Verge
  - Proposed Bus Lane
  - Proposed Cycleway
  - Proposed Footpath
  - Proposed Shared Footpath/Cycleway
  - Proposed Traffic Island
  - Structure (S)
  - Proposed Retaining wall (R)
  - Proposed Culvert (C)
  - Proposed Mammel Underpass (C)
  - Proposed Attenuation Pond / Infiltration Basin / Wetlands
  - Proposed Stream Diversion

- Profile**
- Existing Ground
  - Proposed Geometry Profile
  - FILL 15m +
  - FILL 10m - 15m
  - FILL 05m - 10m
  - FILL 00m - 05m
  - CUT 00m - 05m
  - CUT 05m - 10m
  - CUT 10m - 15m
  - CUT 15m +

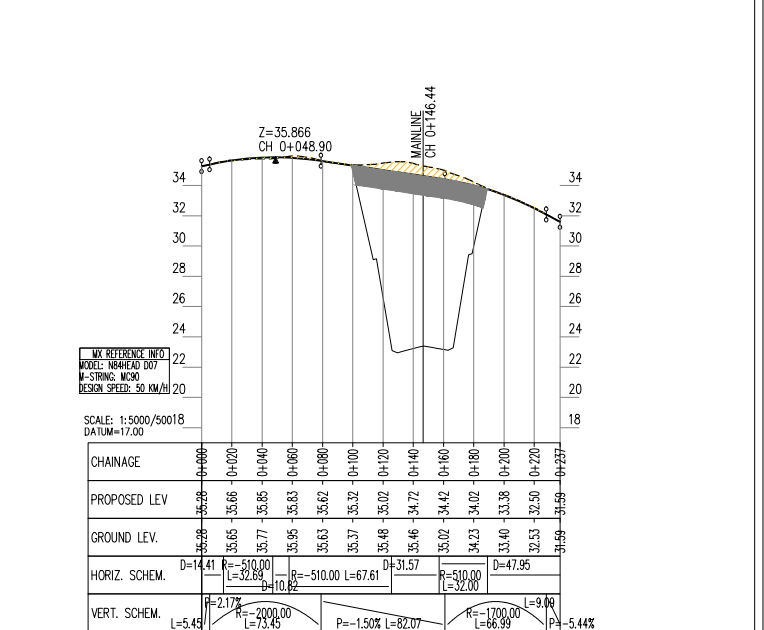
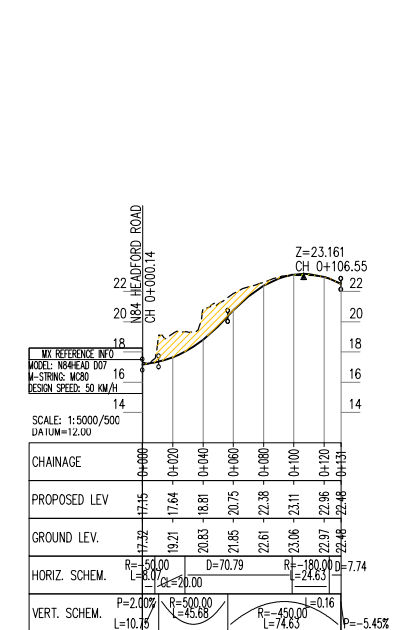
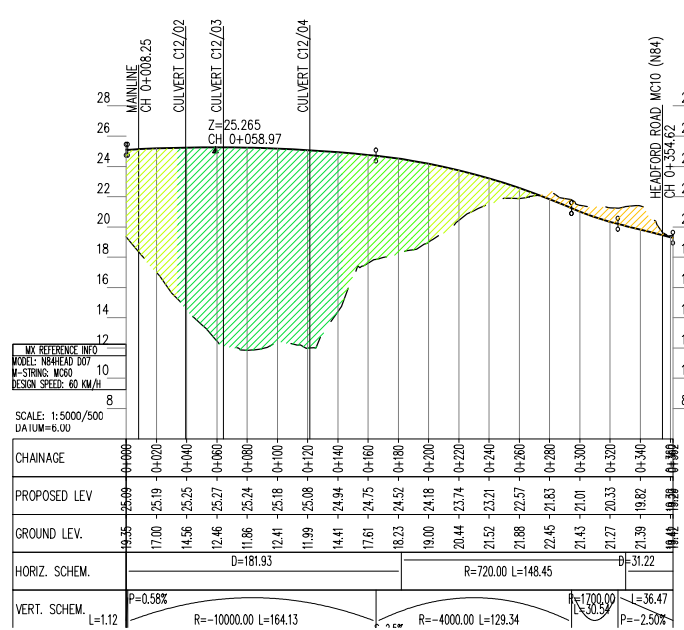
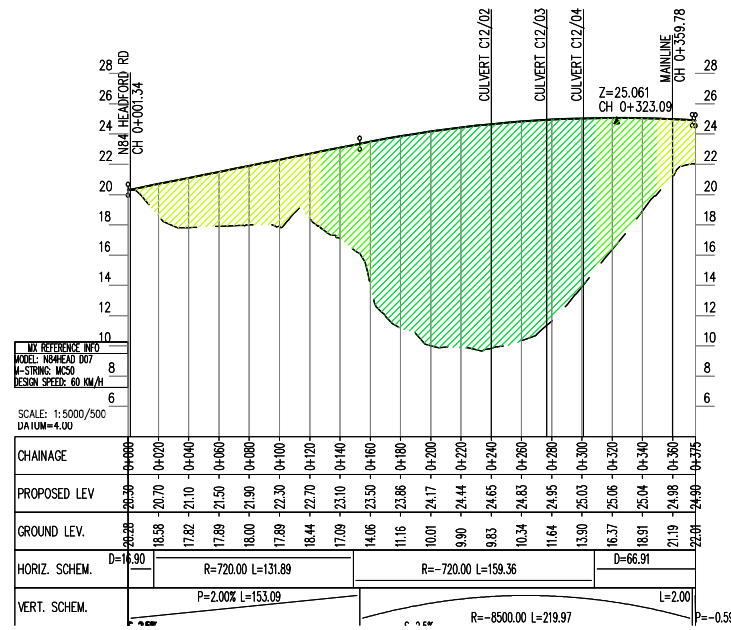

N84 HEADFORD ROAD JUNCTION - EASTBOUND MERGE (MC50)

N84 HEADFORD ROAD JUNCTION - WESTBOUND DIVERGE (MC60)

ACCESS ROAD - (AR 12/01) (MC80)

SCHOOL ROAD CASTLEGAR (MC90)

Sun áiríonn sé go dtéann na sonraí seo a leanas faoi chosaint le hAiríochtaí Geolaíoch agus Ainmneacha Náisiúnaí. © Saibhiríochtaí Ordánais Éireann, 2010. Sáráiríochtaí Ordánais Éireann, 2010. © Saibhiríochtaí Ordánais Éireann, 2010.

© Saibhiríochtaí Ordánais Éireann. Gach ceart ar chosaint. Uimhir cheadainis 2010/20CCMA/Galway County Council na Gaillimhe.

Includes Ordnance Survey Ireland data reproduced under OSI Licence number 2010/20CCMA/Galway County Council. Unauthorised reproduction infringes Ordnance Survey Ireland and Government of Ireland copyright. © Ordnance Survey Ireland, 2010.

© Ordnance Survey Ireland. All rights reserved. Licence number 2010/20CCMA/Galway County Council.

Clients

An Roinn Iompair Turasóireachta agus Spóirt  
Department of Transport, Tourism and Sport

Project Ireland 2040  
The National Development Plan

Galway City Transport Project

Comhairle Chontae na Gaillimhe  
Galway County Council

TIU  
Bonnairíocht Iompair Éireann  
Transport Infrastructure Ireland

Key Plan

Consultant

**ARUP**

Corporate House  
City East Business Park  
Ballybri, Galway, Ireland.

Tel +353 (0)91 460675  
www.N6GalwayCity.ie  
www.arup.ie

Job Title  
**N6 Galway City Ring Road**

Scale  
1:2500/250 @ A1; 1:5000/500 @ A3

Date  
September 2018

Issue	Date	By	Chkd	Appd
I3	17/02/2020	KJ	HK	EMC
I1	28/09/2018	KJ	MG	EMC

Drawing Title  
**Proposed Road Development Plan & Profile  
Headford Road Junction & School Road Castlegar  
Sheet12 of 21**

Drawing Status  
**For Information**

Job No  
**233985**

Drawing No  
**Figure 5.3.12**

Issue  
**13**



EIA REPORT

- Legend:**
- Plan
  - City Boundary
  - Proposed Development Boundary
  - Proposed Road Development
  - Earthworks - Fill
  - Earthworks - Cut
  - Proposed Carriageway Pavement
  - Proposed Grass Verge
  - Proposed Bus Lane
  - Proposed Cycleway
  - Proposed Footpath
  - Proposed Shared Footpath/Cycleway
  - Proposed Traffic Island
  - Structure (S)
  - Proposed Retaining wall (R)
  - Proposed Culvert (C)
  - Proposed Mammal Underpass (C)
  - Proposed Attenuation Pond / Infiltration Basin / Wetlands
  - Proposed Stream Diversion

- Profile**
- Existing Ground
  - Proposed Geometry Profile
  - FILL 15m +
  - FILL 10m - 15m
  - FILL 05m - 10m
  - FILL 00m - 05m
  - CUT 00m - 05m
  - CUT 05m - 10m
  - CUT 10m - 15m
  - CUT 15m +

Son áiríamh tá sonraíocht Shuirbhíreacht Orlándaís Éireann arna aistriú go dtí físeán Chaidéas OSI Uimh. 2010/20CCMA/Comhairle Contae na Gaillimhe. Sárúinn aistriú go dtí na meáin eile ná cúlú. © Suirbhíreacht Orlándaís Éireann, 2010.

© Suirbhíreacht Orlándaís Éireann. Gach ceart ar chosaint. Uimhir cheadúnais 2010/20CCMA/Comhairle Contae na Gaillimhe.

Includes Ordnance Survey Ireland data reproduced under OSI Licence number 2010/20CCMA/Galway County Council. Unauthorised reproduction infringes Ordnance Survey Ireland and Government of Ireland copyright. © Ordnance Survey Ireland, 2010.

© Ordnance Survey Ireland. All rights reserved. Licence number 2010/20CCMA/Galway County Council.

Clients

An Roinn Iompair Turasoireachta agus Spóirt  
Department Transport, Tourism and Sport

Project Ireland 2040  
The Big Ideas for the Future

Galway City Transport Project

Comhairle Chontae na Gaillimhe  
Galway County Council

TII  
Transport Infrastructure Ireland

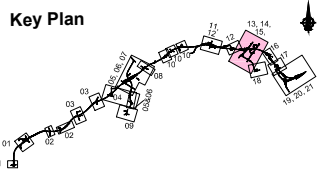

Consultant

**ARUP**

Corporate House  
City East Business Park  
Ballybrit, Galway, Ireland.

Tel +353 (0)91 460675  
www.N6GalwayCity.ie  
www.arup.ie

Job Title  
**N6 Galway City Ring Road**

Scale  
1:2500/250 @ A1; 1:5000/500 @ A3

Date:  
September 2018

Issue	Date	By	Chkd	Appd
I3	17/02/2020	KJ	HK	EMC
I2	22/07/2019	CW	MH	EMC
I1	28/09/2018	KJ	MG	EMC

Drawing Title  
Proposed Road Development Plan & Profile  
N83 Tuam Road & Business Park Junctions Plan  
Sheet 13 of 21

Drawing Status  
**For Information**

Job No  
**233985**

Drawing No  
**Figure 5.3.13**

Issue  
**13**

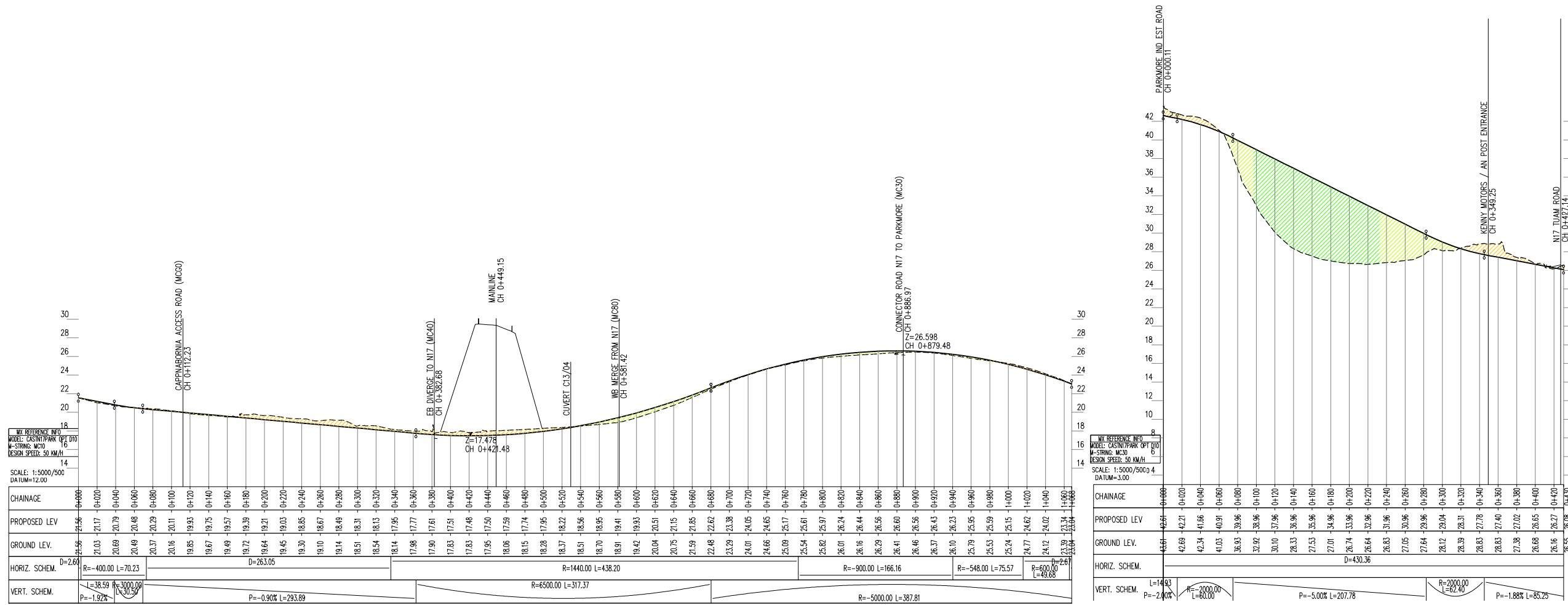

GCR - N17 TUAM ROAD

GCR - N17 - PARKMORE CONNECTOR ROAD

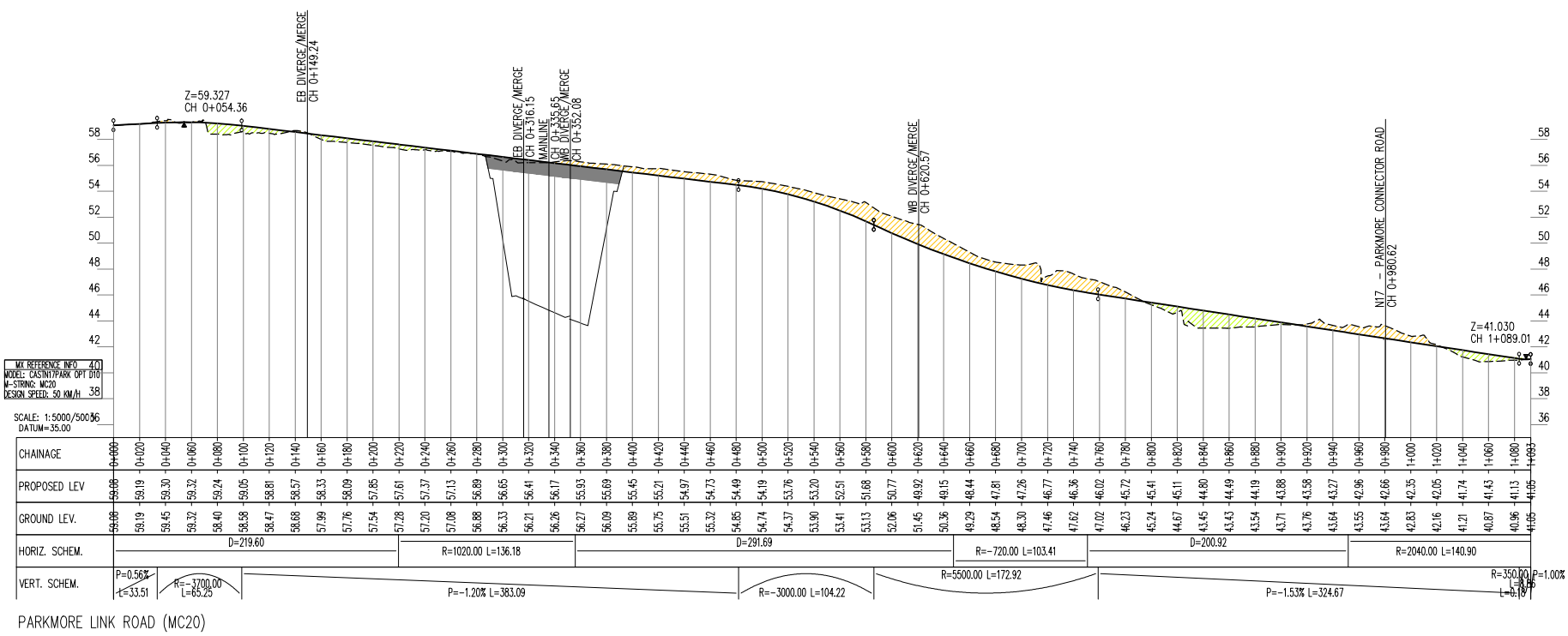

PARKMORE LINK ROAD (MC20)

Sun áiríonn sé sonraíocht Shairbhíreacht Orlándaí Éireann arna áirígeadh faoi Cheadúnas OSI Uimh. 2010/20CCMA/Comhairle Contae na Gaillimhe. Sárúinn áirígeadh neamhdáraithe cóipeacht Shairbhíreacht Orlándaí Éireann agus Rialtas na hÉireann. © Sairbhíreacht Orlándaí Éireann, 2010.

© Sairbhíreacht Orlándaí Éireann. Gach ceart ar chosaint. Uimhir cheadúnais 2010/20CCMA/Comhairle Contae na Gaillimhe.

Includes Ordnance Survey Ireland data reproduced under OSI Licence number 2010/20CCMA/Galway County Council. Unauthorised reproduction infringes Ordnance Survey Ireland and Government of Ireland copyright. © Ordnance Survey Ireland, 2010.

© Ordnance Survey Ireland. All rights reserved. Licence number 2010/20CCMA/Galway County Council.

Clients

An Roinn Iompair  
Turasóireachta agus Spóirt  
Department Transport, Tourism and Sport

Project Ireland 2040  
The National Planning Framework

Galway City Transport Project

Comhairle Chontae na Gaillimhe  
Galway County Council

TIIV  
Iompartha Iompair Éireann  
Transport Infrastructure Ireland

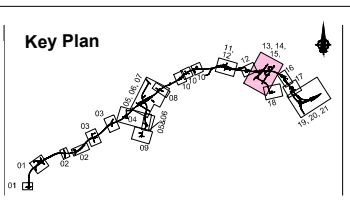

Consultant

**ARUP**

Corporate House  
City East Business Park  
Ballybirr, Galway, Ireland.

Tel +353 (0)91 460675  
www.N6GalwayCity.ie  
www.arup.ie

Job Title

**N6 Galway City Ring Road**

Scale

1:2500/250 @ A1; 1:5000/500 @ A3

Date

September 2018

Issue	Date	By	Chkd	Appd
13	17/02/2020	KJ	HK	EMC
11	28/09/2018	KJ	MG	EMC

Drawing Title

**Proposed Road Development Plan & Profile  
N83 Tuam Road & Business Park Junctions Profiles  
Sheet 14 of 21**

Drawing Status

**For Information**

Job No	Drawing No	Issue
233985	Figure 5.3.14	13

Legend:

- Profile**
- Existing Ground
  - Proposed Geometry Profile
  - FILL 15+m
  - FILL 10m - 15m
  - FILL 05m - 10m
  - FILL 00m - 05m
  - CUT 00m - 05m
  - CUT 05m - 10m
  - CUT 10m - 15m
  - CUT 15+m

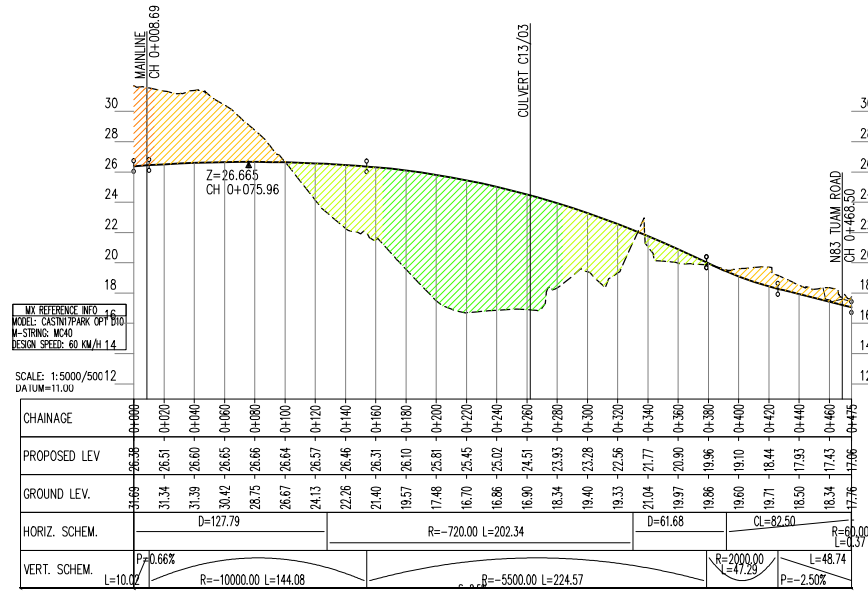

EASTBOUND DIVERGE TO N83 TUAM ROAD (MC40)

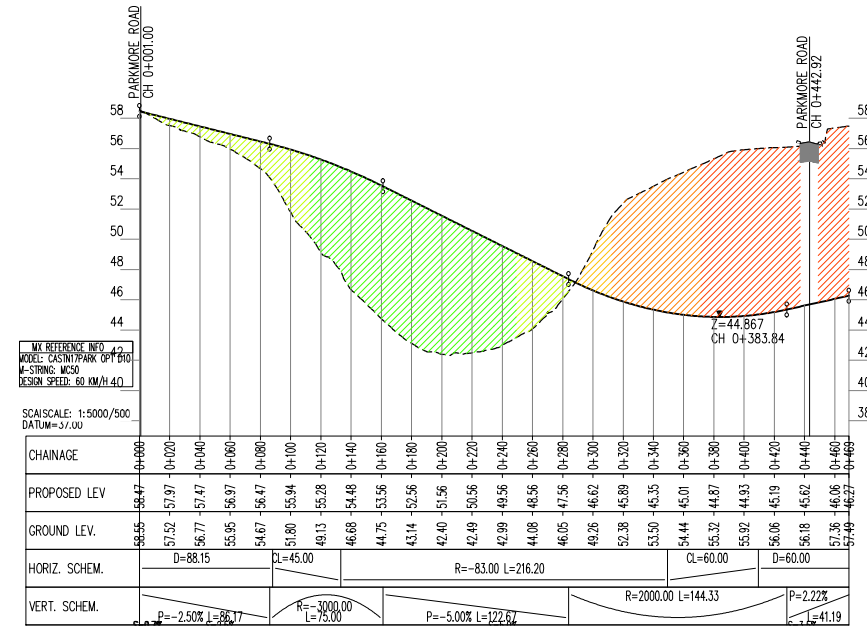

EASTBOUND MERGE FROM PARKMORE LINK ROAD (MC50)

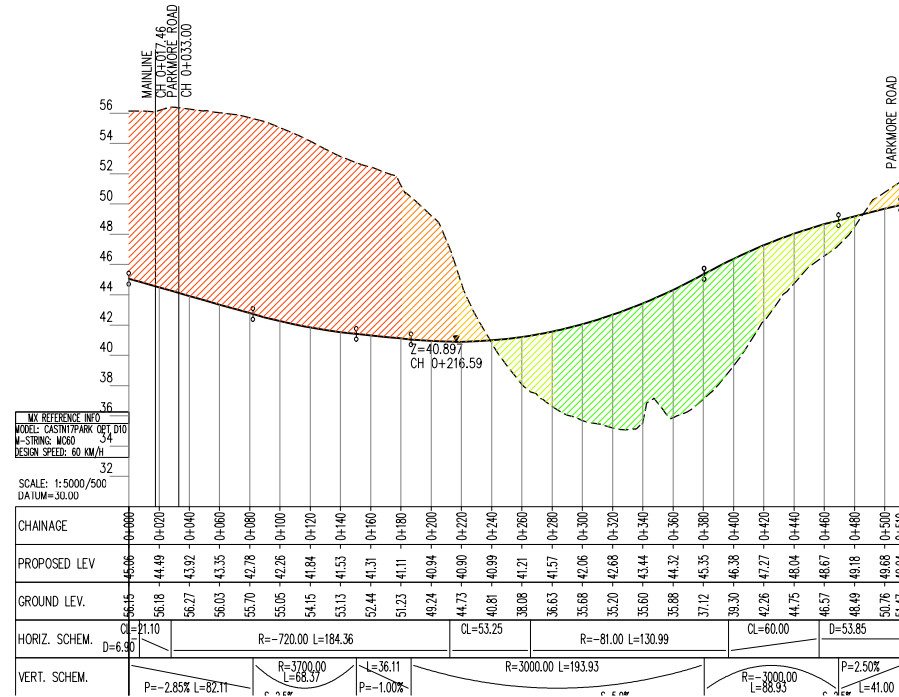

WESTBOUND DIVERGE TO PARKMORE LINK ROAD (MC60)

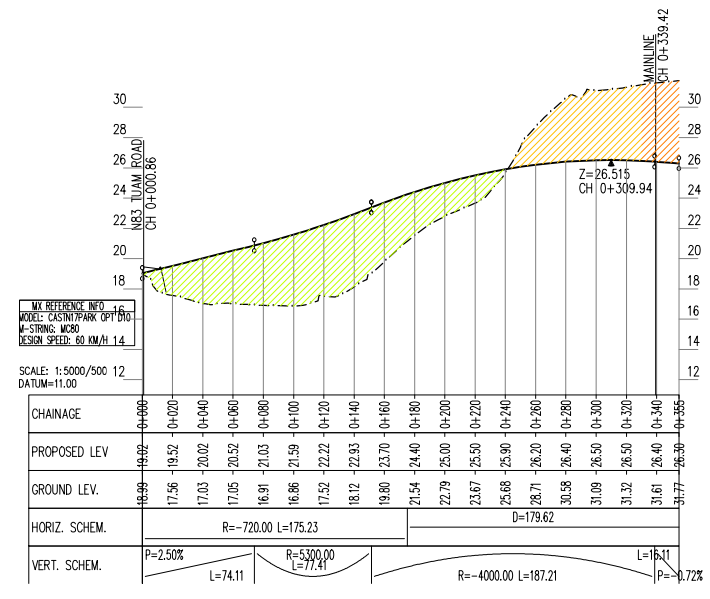

WESTBOUND MERGE FROM N83 TUAM ROAD (MC80)

San áiríamh tá sonraíocht Shairbhéiríochta Orlándaí Éireann arna aistriú go dtí físeánúis OSI Uimh. 2010/20CCMA/Comhairle Contae na Gaillimhe. Sárúilíon aistriú go dtí na meáin eile ná cúlchruinníocht Shairbhéiríochta Orlándaí Éireann agus Rialtas na hÉireann. © Sairbhéiríochta Orlándaí Éireann, 2010.

© Sairbhéiríochta Orlándaí Éireann. Gach ceart ar chosaint. Uimhir cheadúnais 2010/20CCMA/Comhairle Contae na Gaillimhe.

Includes Ordnance Survey Ireland data reproduced under OSI Licence number 2010/20CCMA/Galway County Council. Unauthorised reproduction infringes Ordnance Survey Ireland and Government of Ireland copyright. © Ordnance Survey Ireland, 2010.

© Ordnance Survey Ireland. All rights reserved. Licence number 2010/20CCMA/Galway County Council.

Clients

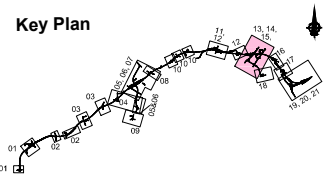

Consultant

Corporate House  
City East Business Park  
Ballybrit, Galway, Ireland.

Tel +353 (0)91 460675  
www.N6GalwayCity.ie  
www.arup.ie

Job Title  
**N6 Galway City Ring Road**

Scale  
1:2500/250 @ A1; 1:5000/500 @ A3

Date  
September 2018

Issue	Date	By	Chkd	Appd
13	17/02/2020	KJ	HK	EMC
11	28/09/2018	KJ	MG	EMC

Drawing Title  
**Proposed Road Development Plan & Profile N83 Tuam Road & Business Park Junctions Profiles Sheet 15 of 21**

Drawing Status  
**For Information**

Job No  
**233985**

Drawing No  
**Figure 5.3.15**

Issue  
**13**

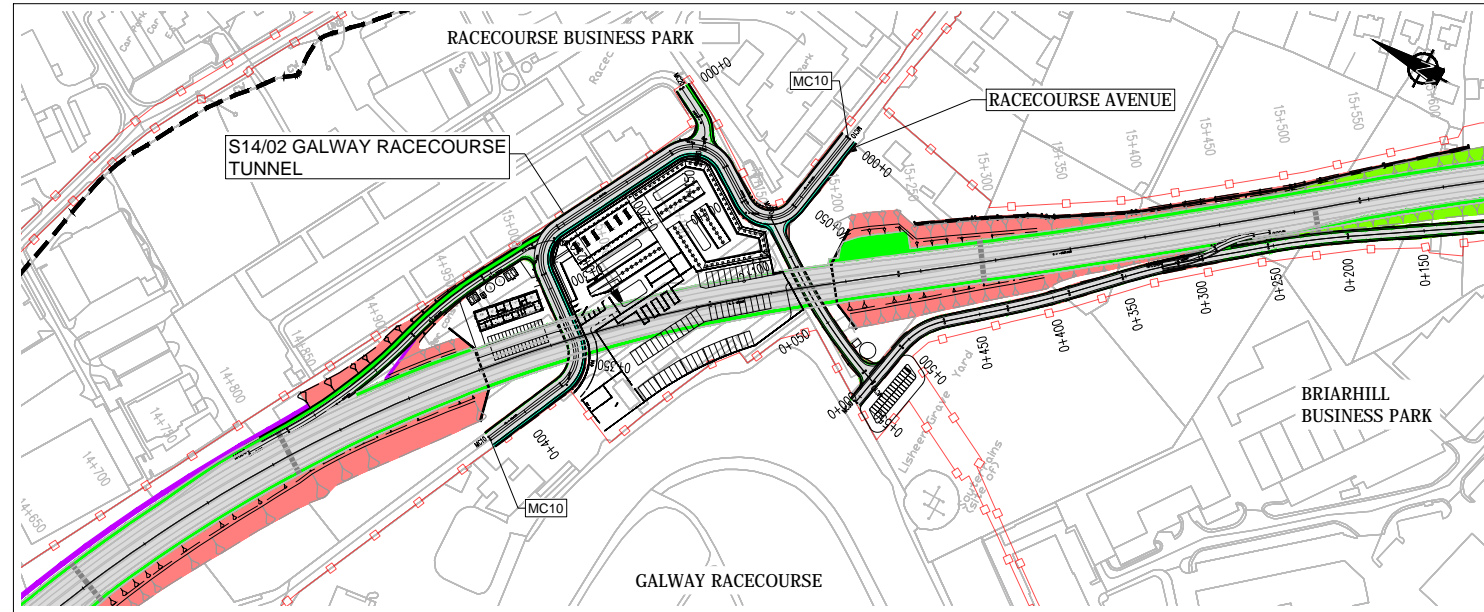

- Legend:**
- Plan
  - City Boundary
  - Proposed Development Boundary
  - Proposed Road Development
  - Earthworks - Fill
  - Earthworks - Cut
  - Proposed Carriageway Pavement
  - Proposed Grass Verge
  - Proposed Bus Lane
  - Proposed Cycleway
  - Proposed Footpath
  - Proposed Shared Footpath/Cycleway
  - Proposed Traffic Island
  - Structure (S)
  - Proposed Retaining wall (R)
  - Proposed Culvert (C)
  - Proposed Mammal Underpass (C)
  - Proposed Attenuation Pond / Infiltration Basin / Wetlands
  - Proposed Stream Diversion

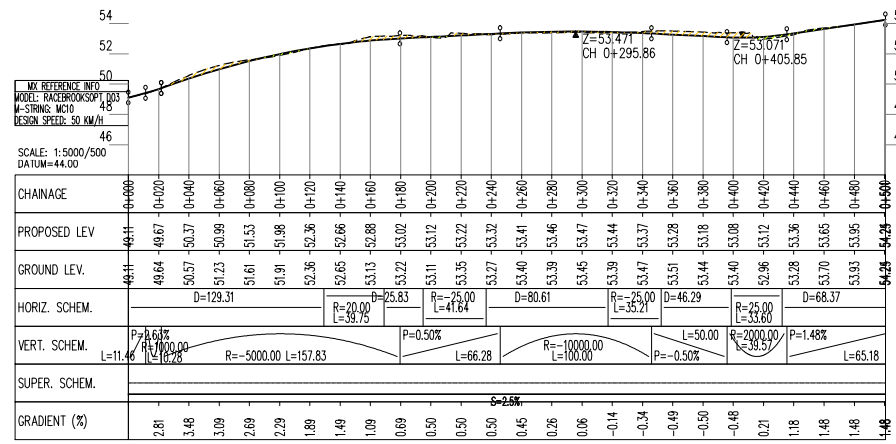

REALIGNED RACECOURSE AVENUE (MC10)

**Profile**

- Existing Ground
- Proposed Geometry Profile
- FILL 15m +
- FILL 10m - 15m
- FILL 05m - 10m
- FILL 00m - 05m
- CUT 00m - 05m
- CUT 05m - 10m
- CUT 10m - 15m
- CUT 15m +

San áiríúmh tá sonraíocht Shairbhéireacht Orlándaí Éireann arna aistriú go dtí físeán OSI Uimh. 2010/20CCMA/Comhairle Contae na Gaillimhe. Sárúimh aistriú go dtí neamhdátaíocht cóipeacht Shairbhéireacht Orlándaí Éireann agus Rialtas na hÉireann. © Sairbhéireacht Orlándaí Éireann, 2010.

© Sairbhéireacht Orlándaí Éireann. Gach ceart ar chosaint. Uimhir cheadúnais 2010/20CCMA/Comhairle Contae na Gaillimhe.

Includes Ordnance Survey Ireland data reproduced under OSI Licence number 2010/20CCMA/Galway County Council. Unauthorised reproduction infringes Ordnance Survey Ireland and Government of Ireland copyright. © Ordnance Survey Ireland, 2010.

© Ordnance Survey Ireland. All rights reserved. Licence number 2010/20CCMA/Galway County Council.

Clients

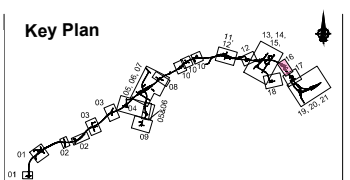

Consultant

Corporate House  
City East Business Park  
Ballybrit, Galway, Ireland.

Tel +353 (0)91 460675  
www.N6GalwayCity.ie  
www.arup.ie

Job Title  
**N6 Galway City Ring Road**

Scale  
1:2500/250 @ A1; 1:5000/500 @ A3

Date:  
September 2018

Issue	Date	By	Chkd	Appd
I3	17/02/2020	KJ	HK	EMC
I1	28/09/2018	KJ	MG	EMC

Drawing Title  
Proposed Road Development Plan & Profile  
Racecourse Business Park Junctions Plan  
Sheet 16 of 21

Drawing Status  
**For Information**

Job No  
**233985**

Drawing No  
**Figure 5.3.16**

Issue  
**I3**



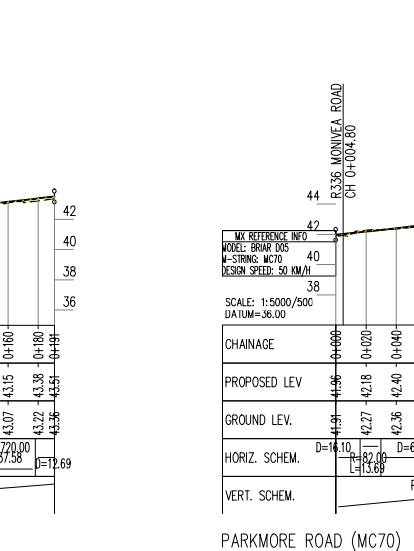
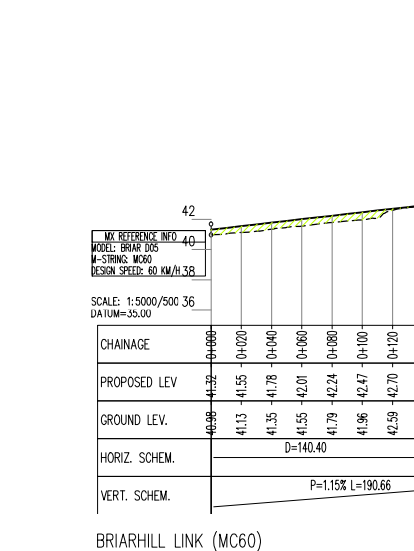
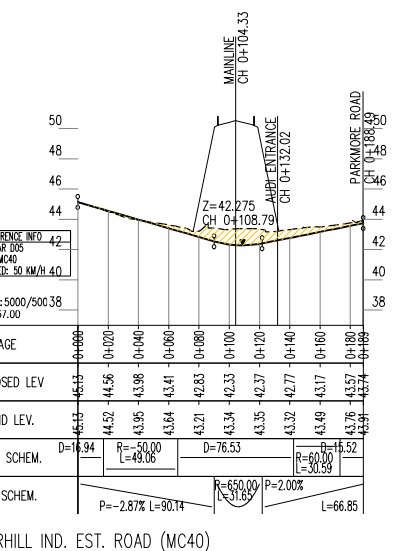
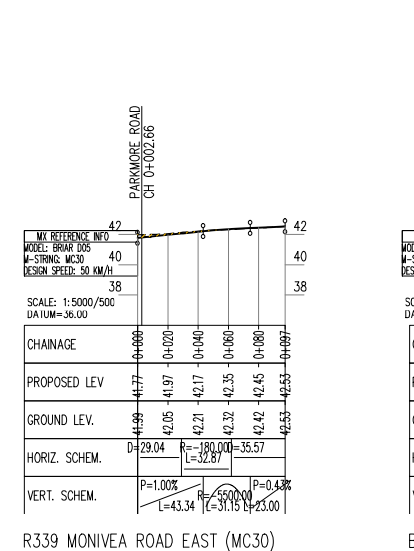
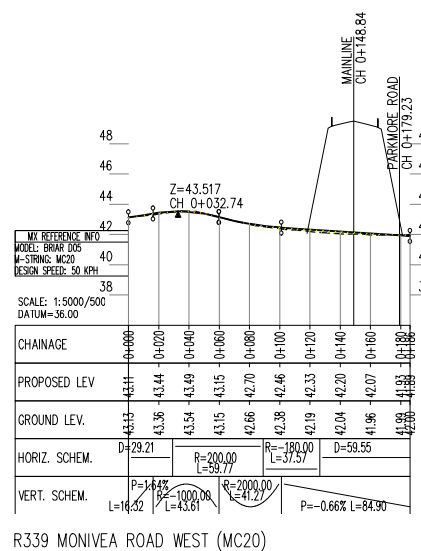
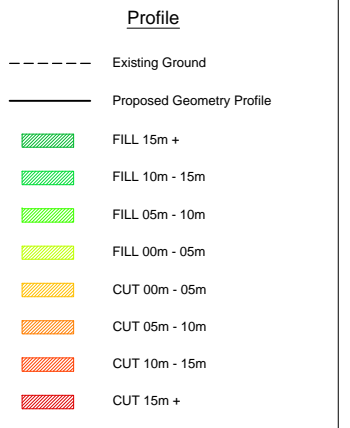
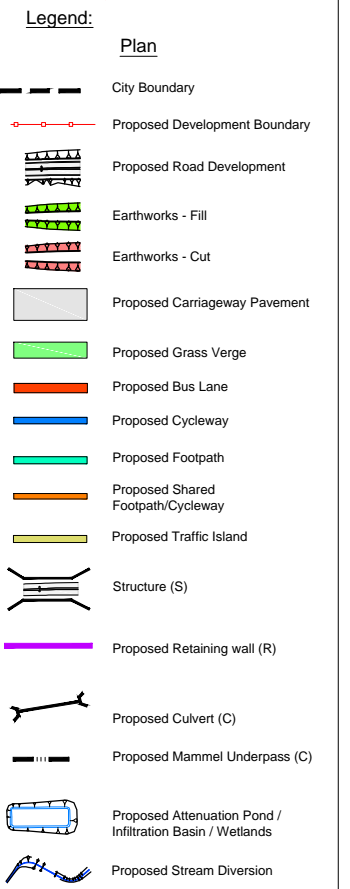
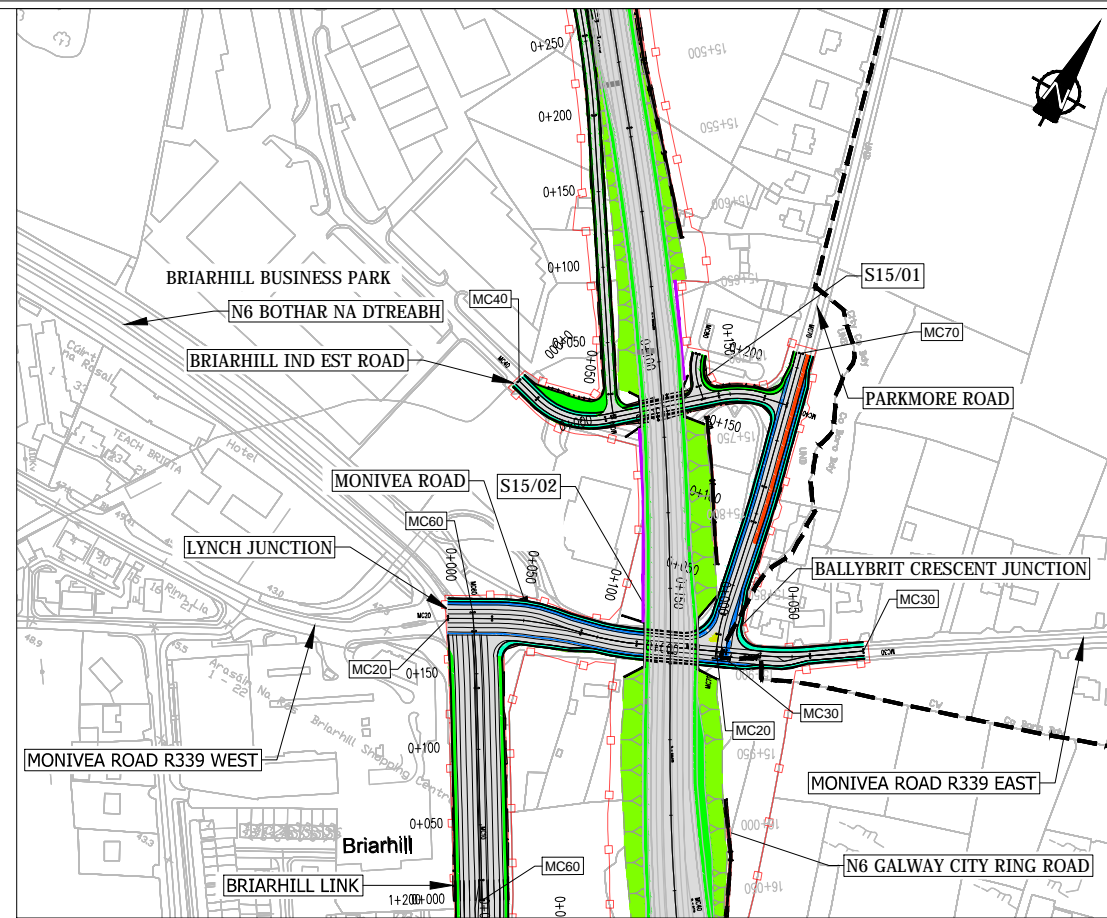

Sun áiríúmh tá sonraíocht Shuirbhíreacht Orlándaí Éireann arna áiríú geallfáil fíor Chéadúnaí OSI Uimh. 2010/20CCMA/Comhairle Contae na Gaillimhe. Sárúilíonn áiríú geallfáil neamhdáiríthe cóipeacht Shuirbhíreacht Orlándaí Éireann agus Rialtas na hÉireann. © Suirbhíreacht Orlándaí Éireann, 2010.

© Suirbhíreacht Orlándaí Éireann. Gach ceart ar chosaint. Uimhir cheadúnais 2010/20CCMA/Comhairle Contae na Gaillimhe.

Includes Ordnance Survey Ireland data reproduced under OSI Licence number 2010/20CCMA/Galway County Council. Unauthorised reproduction infringes Ordnance Survey Ireland and Government of Ireland copyright. © Ordnance Survey Ireland, 2010.

© Ordnance Survey Ireland. All rights reserved. Licence number 2010/20CCMA/Galway County Council.

**Clients**

An Roinn Iompair Turasoireachta agus Spóirt  
Department Transport, Tourism and Sport

Project Ireland 2040  
The National Planning Framework

Galway City Transport Project

**Key Plan**

**Consultant**

**ARUP**

Corporate House  
City East Business Park  
Ballybrit, Galway, Ireland.

Tel +353 (0)91 460675  
www.N6GalwayCity.ie  
www.arup.ie

Job Title  
**N6 Galway City Ring Road**

Scale  
1:2500/250 @ A1; 1:5000/500 @ A3

Date:  
September 2018

Issue	Date	By	Chkd	Appd
13	17/02/2020	KJ	HK	EMC
11	28/09/2018	KJ	MG	EMC

Drawing Title  
**Proposed Road Development Plan & Profile Ballybrit Crescent Junctions**

Sheet 17 of 21

Drawing Status  
**For Information**

Job No  
**233985**

Drawing No  
**Figure 5.3.17**

Issue  
**13**

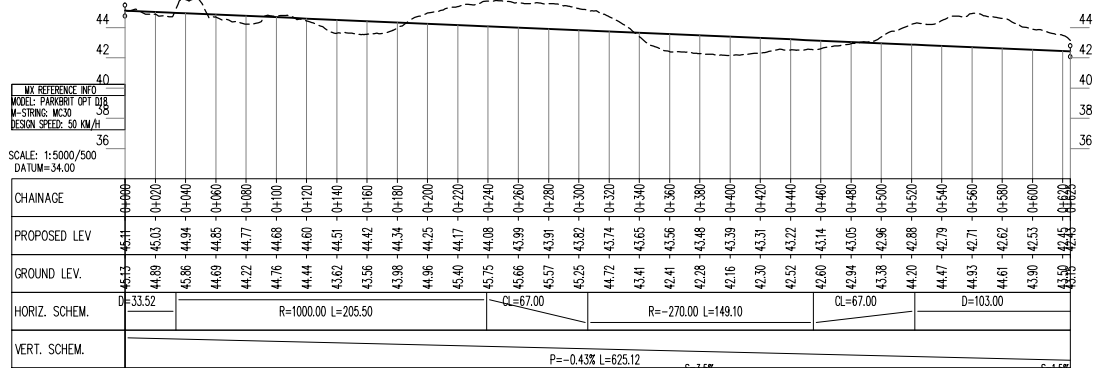
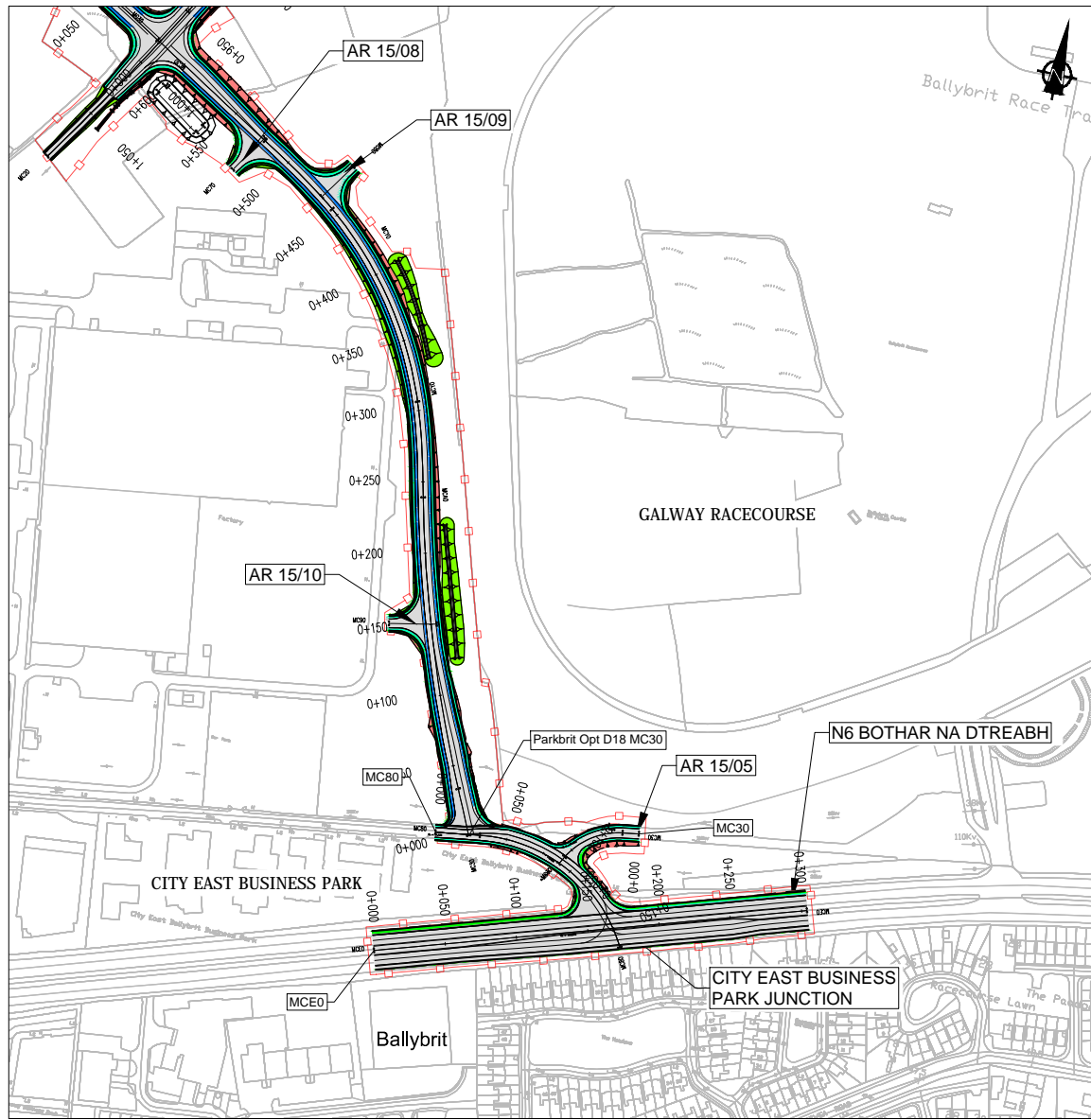

- Legend:**
- Plan
  - City Boundary
  - Proposed Development Boundary
  - Proposed Road Development
  - Earthworks - Fill
  - Earthworks - Cut
  - Proposed Carriageway Pavement
  - Proposed Grass Verge
  - Proposed Bus Lane
  - Proposed Cycleway
  - Proposed Footpath
  - Proposed Shared Footpath/Cycleway
  - Proposed Traffic Island
  - Structure (S)
  - Proposed Retaining wall (R)
  - Proposed Culvert (C)
  - Proposed Mammal Underpass (C)
  - Proposed Attenuation Pond / Infiltration Basin / Wetlands
  - Proposed Stream Diversion

- Profile**
- Existing Ground
  - Proposed Geometry Profile
  - FILL 15m +
  - FILL 10m - 15m
  - FILL 05m - 10m
  - FILL 00m - 05m
  - CUT 00m - 05m
  - CUT 05m - 10m
  - CUT 10m - 15m
  - CUT 15m +

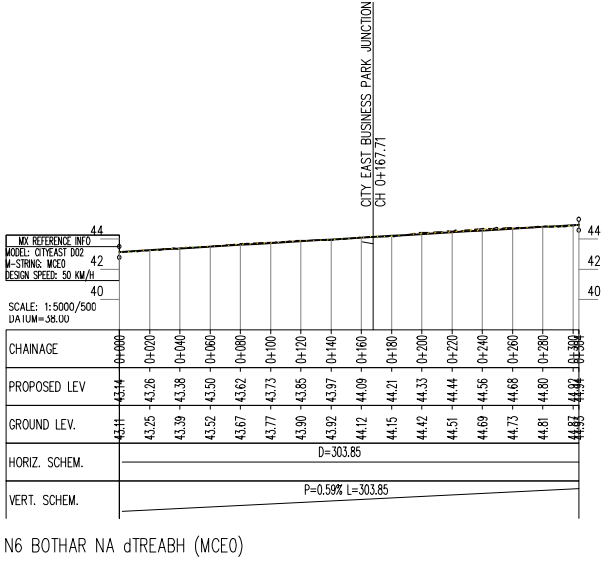
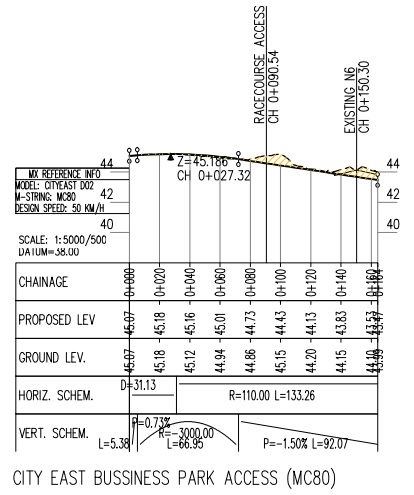
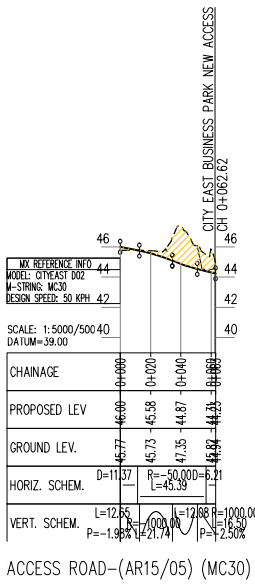

Sun áiríonn sé sonraíocht Shairbhíreacht Orlándaí Éireann arna aistriú go dtí fíor Cheadúnas OSI Uimh. 2010/20CCMA/Comhairle Contae na Gaillimhe. Sárúinn aistriú go dtí neamháráithe cóipeacht Shairbhíreacht Orlándaí Éireann agus Rialtas na hÉireann. © Sairbhíreacht Orlándaí Éireann, 2010.

© Sairbhíreacht Orlándaí Éireann. Gach ceart ar chosaint. Uimhir cheadúnais 2010/20CCMA/Comhairle Contae na Gaillimhe.

Includes Ordnance Survey Ireland data reproduced under OSI Licence number 2010/20CCMA/Galway County Council. Unauthorised reproduction infringes Ordnance Survey Ireland and Government of Ireland copyright. © Ordnance Survey Ireland, 2010.

© Ordnance Survey Ireland. All rights reserved. Licence number 2010/20CCMA/Galway County Council.

Clients

An Roinn Iompair Turasoireachta agus Spóirt  
Department Transport, Tourism and Sport

Project Ireland 2040  
The National Development Plan

Galway City Transport Project

Comhairle Chontae na Gaillimhe  
Galway County Council

TIU  
Transport Infrastructure Unit

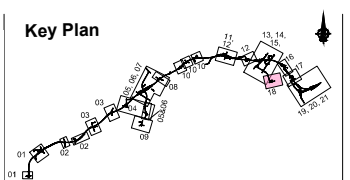

Consultant

**ARUP**

Corporate House  
City East Business Park  
Ballybrit, Galway, Ireland.

Tel +353 (0)91 460675  
www.GalwayCity.ie  
www.arup.ie

Job Title  
**N6 Galway City Ring Road**

Scale  
1:2500/250 @ A1; 1:5000/500 @ A3

Date  
September 2018

Issue	Date	By	Chkd	Appd
13	17/02/2020	KJ	HK	EMC
11	28/09/2018	KJ	MG	EMC

**For Information**

Job No	Drawing No	Issue
233985	Figure 5.3.18	13

Drawing Title  
**Proposed Road Development Plan & Profile  
City East Business Park, Parkmore Link Road (Mod.)  
Sheet 18 of 21**

Drawing Status

**For Information**

Job No: 233985  
Drawing No: Figure 5.3.18  
Issue: 13

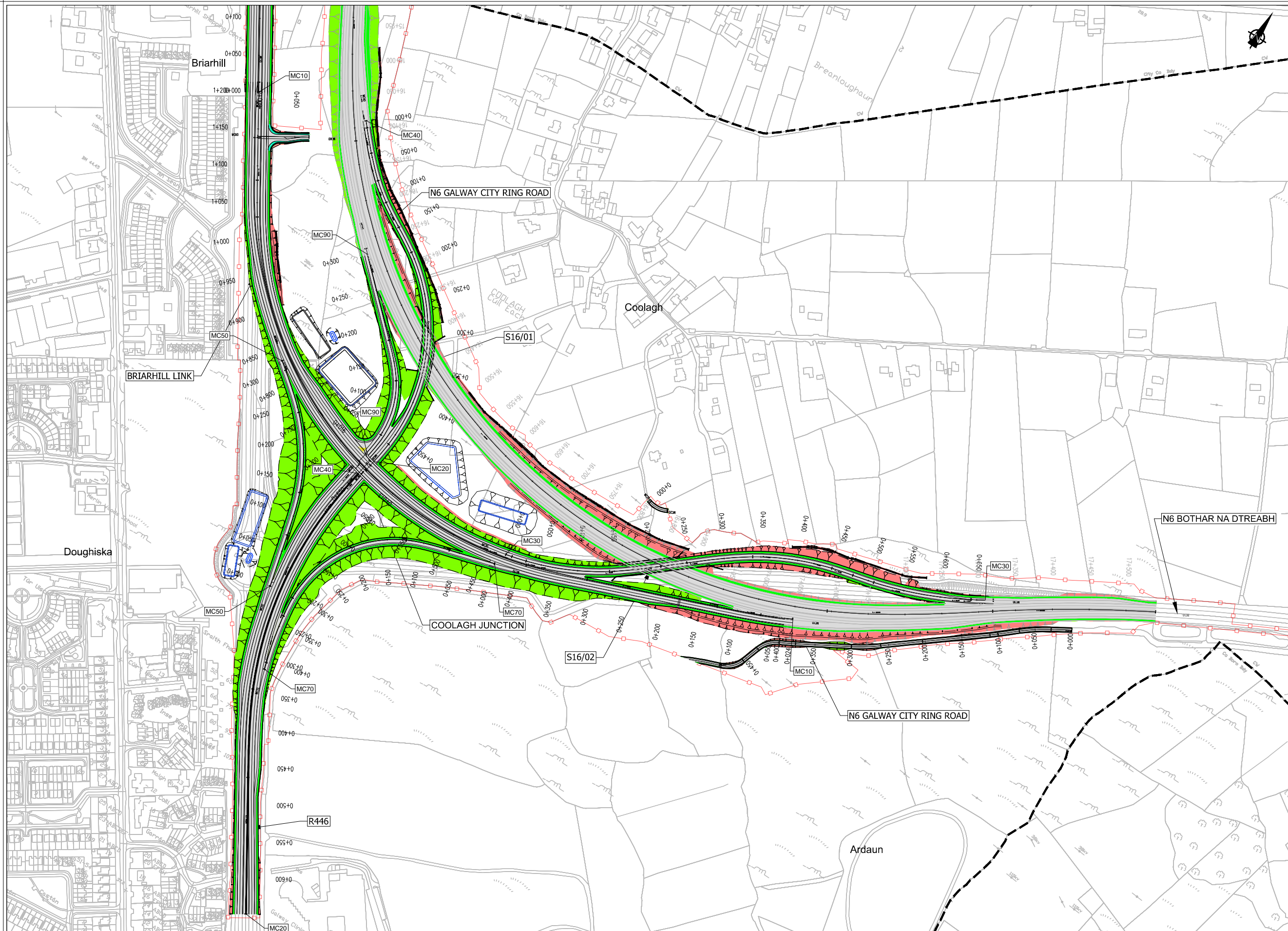

- Legend:**
- Plan
  - City Boundary
  - Proposed Development Boundary
  - Proposed Road Development
  - Earthworks - Fill
  - Earthworks - Cut
  - Proposed Carriageway Pavement
  - Proposed Grass Verge
  - Proposed Bus Lane
  - Proposed Cycleway
  - Proposed Footpath
  - Proposed Shared Footpath/Cycleway
  - Proposed Traffic Island
  - Structure (S)
  - Proposed Retaining wall (R)
  - Proposed Culvert (C)
  - Proposed Mammal Underpass (C)
  - Proposed Attenuation Pond / Infiltration Basin / Wetlands
  - Proposed Stream Diversion

- Profile**
- Existing Ground
  - Proposed Geometry Profile
  - FILL 15m +
  - FILL 10m - 15m
  - FILL 05m - 10m
  - FILL 00m - 05m
  - CUT 00m - 05m
  - CUT 05m - 10m
  - CUT 10m - 15m
  - CUT 15m +

Sun áiríamh tá sonraíocht Shuirbhíreacht Orlándaís Éireann arna aistriú go dtí físeán Chéadúna OSÍ Uimh. 2010/20CCMA/Comhairle Contae na Gaillimhe. Sárúinn aistriú go dtí neamháráithe cóipeacht Shuirbhíreacht Orlándaís Éireann agus Rialtas na hÉireann. © Suirbhíreacht Orlándaís Éireann, 2010.

© Suirbhíreacht Orlándaís Éireann. Gach ceart ar chosaint. Uimhir cheadúnaís 2010/20CCMA/Comhairle Contae na Gaillimhe.

Includes Ordnance Survey Ireland data reproduced under OSI Licence number 2010/20CCMA/Galway County Council. Unauthorised reproduction infringes Ordnance Survey Ireland and Government of Ireland copyright. © Ordnance Survey Ireland, 2010.

© Ordnance Survey Ireland. All rights reserved. Licence number 2010/20CCMA/Galway County Council.

Clients

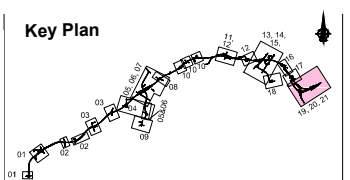

Consultant

Corporate House  
City East Business Park  
Ballybrit, Galway, Ireland.

Tel +353 (0)91 460675  
www.N6GalwayCity.ie  
www.arup.ie

Job Title  
**N6 Galway City Ring Road**

Scale  
1:2500/250 @ A1; 1:5000/500 @ A3

Date:  
September 2018

Issue	Date	By	Chkd	Appd
13	17/02/2020	KJ	HK	EMC
11	28/09/2018	KJ	MG	EMC

Drawing Title  
Proposed Road Development Plan & Profile  
Coolagh Junction Plan  
Sheet 19 of 21

Drawing Status  
**For Information**

Job No  
**233985**

Drawing No  
**Figure 5.3.19**

Issue  
**13**

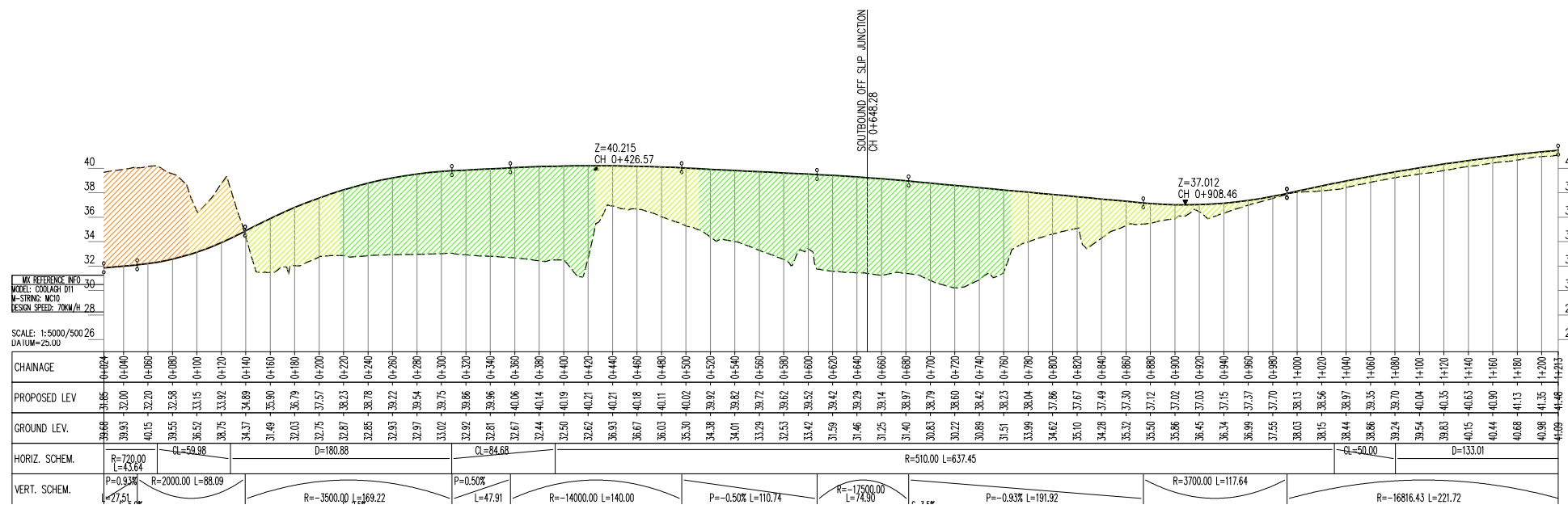

COOLAGH JUNCTION : WESTBOUND DIVERGE TO BRIARHILL LINK FROM EXISTING M6 (MC10)

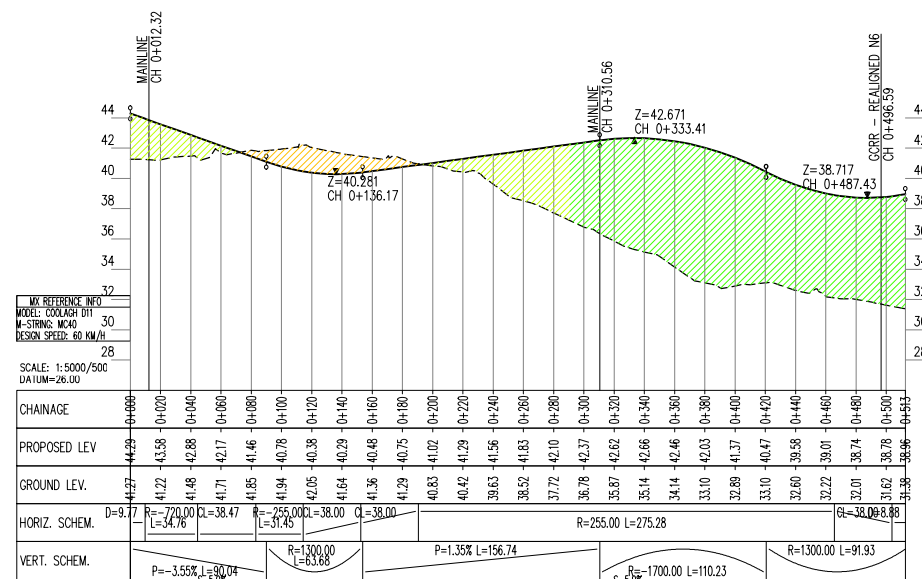

EASTBOUND DIVERGE TO COOLAGH JUNCTION (MC40)

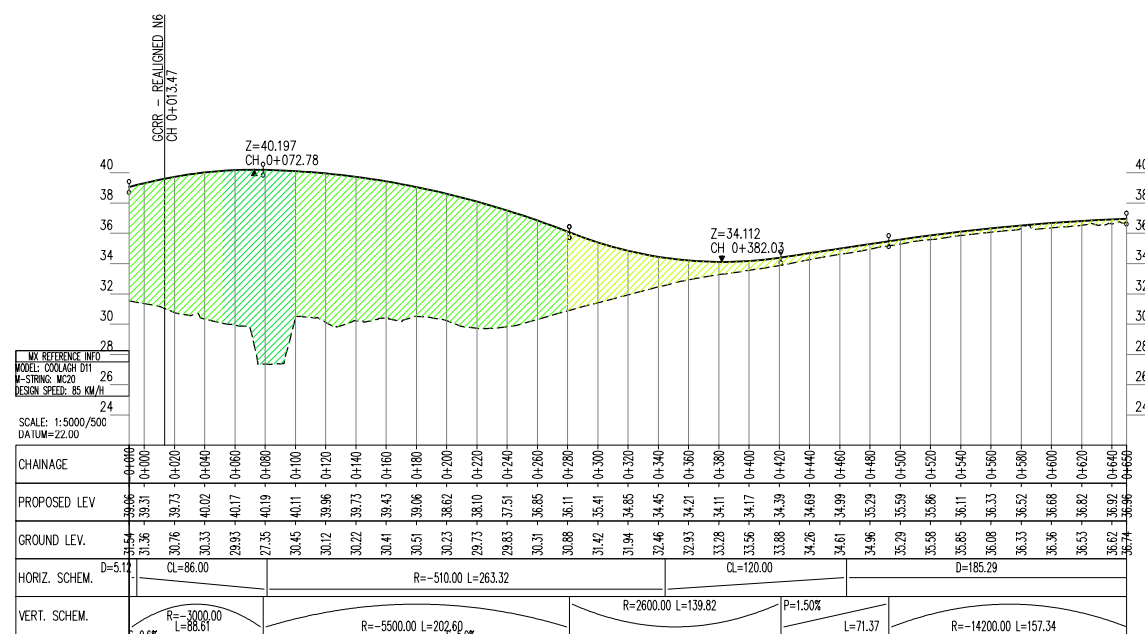

R446 SOUTH TO MARTIN ROUNDABOUT (MC20)

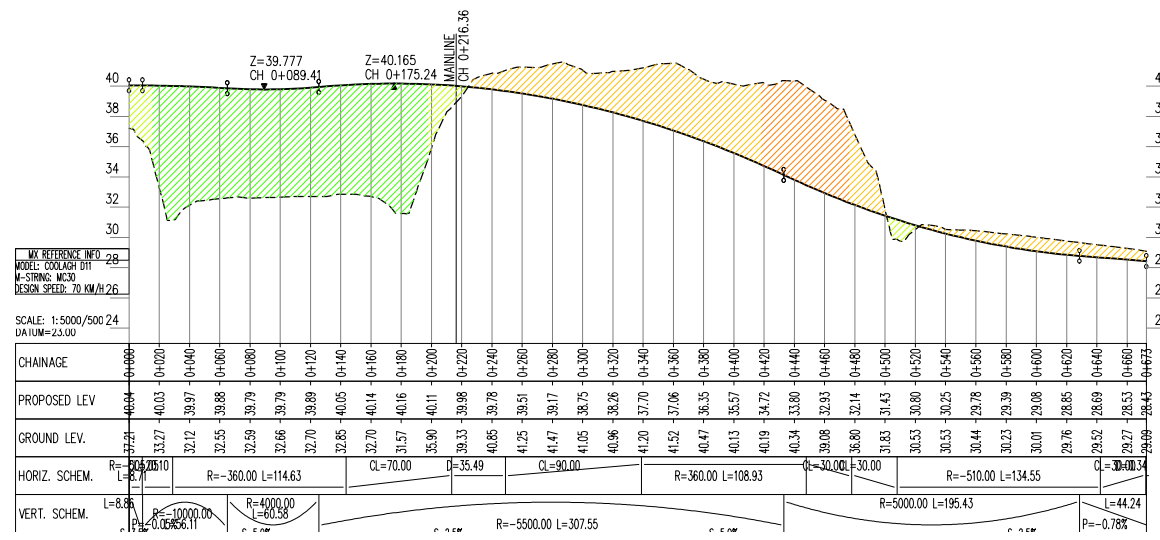

BRIARHILL LINK TO EXISTING M6 (MC30)

**Legend:**

**Profile**

- Existing Ground
- Proposed Geometry Profile
- FILL 15+m
- FILL 10m - 15m
- FILL 05m - 10m
- FILL 00m - 05m
- CUT 00m - 05m
- CUT 05m - 10m
- CUT 10m - 15m
- CUT 15+m

San áiríonn tá sonraíocht Shuirbhíreacht Orlándaí Éireann arna áiríteadh fíor Chuidínas OSI Uimh. 2010/20CCMA/Comhairle Contae na Gaillimhe. Sárúinn áiríteadh namháidaráithe cóipeacht Shuirbhíreacht Orlándaí Éireann agus Rialtas na hÉireann. © Suirbhíreacht Orlándaí Éireann, 2010.

© Suirbhíreacht Orlándaí Éireann. Gach ceart ar chosaint. Uimhir cheadúnais 2010/20CCMA/Comhairle Contae na Gaillimhe.

Includes Ordnance Survey Ireland data reproduced under OSI Licence number 2010/20CCMA/Galway County Council. Unauthorised reproduction infringes Ordnance Survey Ireland and Government of Ireland copyright. © Ordnance Survey Ireland, 2010.

© Ordnance Survey Ireland. All rights reserved. Licence number 2010/20CCMA/Galway County Council.

Clients

An Roinn Iompair  
Turasóireachta agus Spóirt  
Department Transport, Tourism and Sport

Project Ireland 2040  
The Big Idea  
Ireland

Galway City Transport Project

Comhairle Chontae na Gaillimhe  
Galway County Council

TIIV  
Transport Infrastructure Ireland

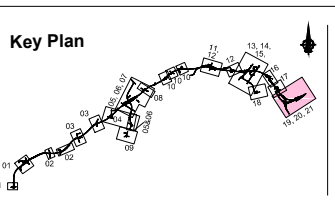

Consultant

**ARUP**

Corporate House  
City East Business Park  
Ballybriff, Galway, Ireland.

Tel +353 (0)91 460675  
www.N6GalwayCity.ie  
www.arup.ie

Job Title  
**N6 Galway City Ring Road**

Scale  
1:2500/250 @ A1; 1:5000/500 @ A3

Date:  
September 2018

Issue	Date	By	Chkd	Appd
13	17/02/2020	KJ	HK	EMC
11	28/09/2018	KJ	MG	EMC

**For Information**

Job No	Drawing No	Issue
233985	Figure 5.3.20	13

Drawing Title  
**Proposed Road Development Plan & Profile  
Coolagh Junction Profiles  
Sheet 20 of 21**

Drawing Status  
**For Information**

Job No  
**233985**

Drawing No  
**Figure 5.3.20**

Issue  
**13**

Legend:

- Profile**
- Existing Ground
  - Proposed Geometry Profile
  - FILL 15+m
  - FILL 10m - 15m
  - FILL 05m - 10m
  - FILL 00m - 05m
  - CUT 00m - 05m
  - CUT 05m - 10m
  - CUT 10m - 15m
  - CUT 15+m

